

Coolant Capacity=5200 Watt
BEARINGS GREASE LUBRICATION

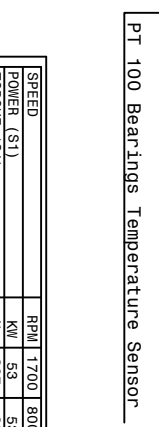
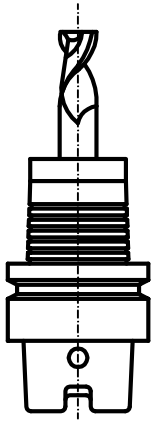
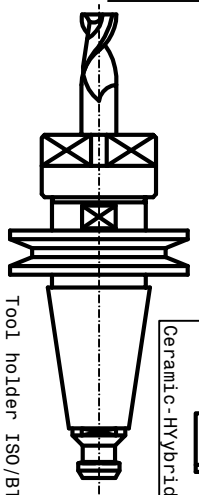
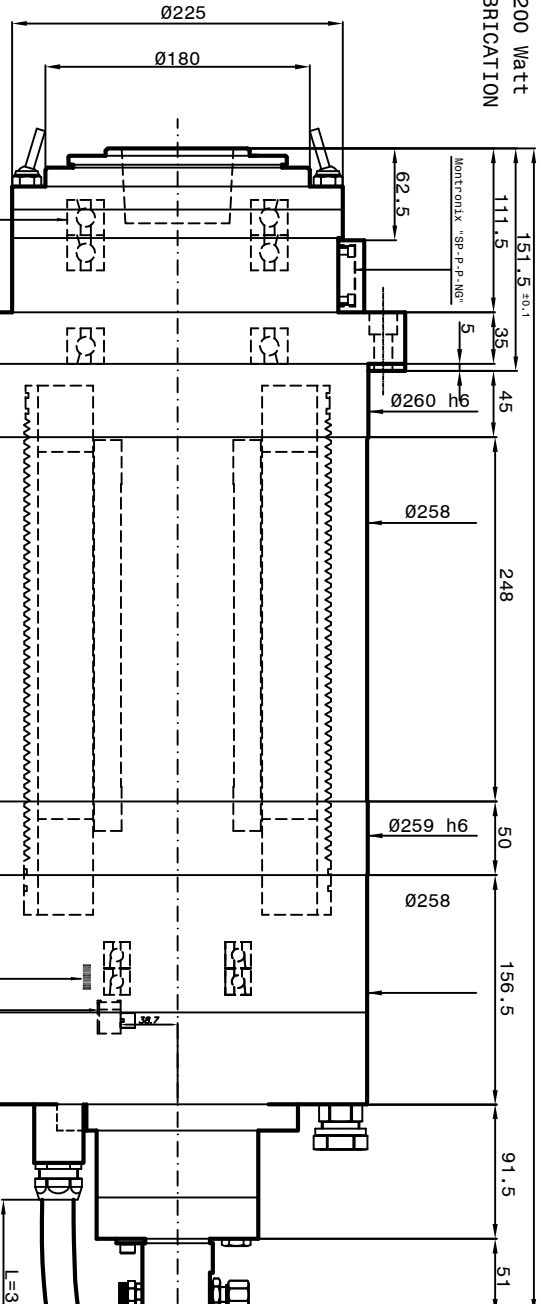
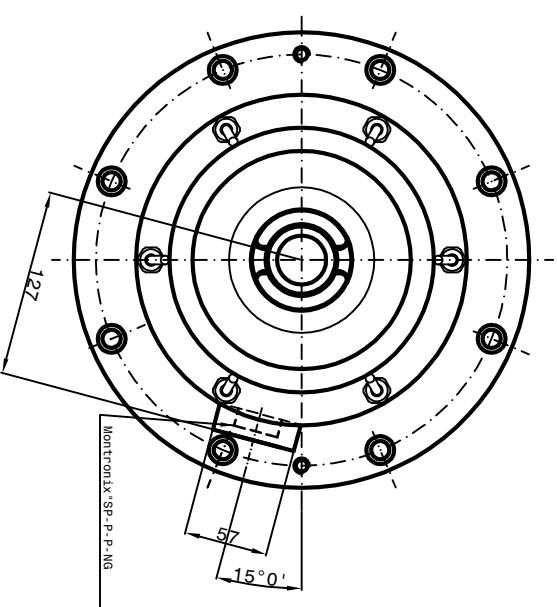
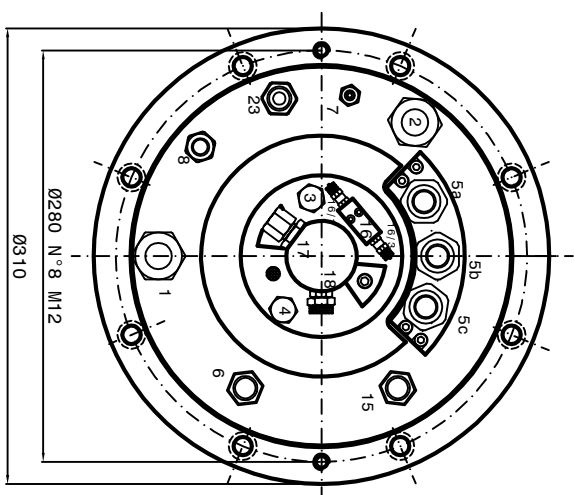

- 1-Coolant inlet (G1/2") (3+4 bar) (8 l/min.)
- 2-Coolant outlet (G1/2") ()
- 3-Hydraulic pressure unclamping tool (50 bar min. 90bar max) (G1/4")
- 4-Hydraulic pressure clamping tool (10bar) (G1/4")
- 5-Electric connection L=300mm
- 3Phases motor Earth + Earth Ø 10 n°1 cable
- Phase V Ø 11 n°1 cable
- Phase W Ø 11 n°1 cable
- Phase U Ø 11 n°1 cable
- 6-Outlet sensor's cables (S1-S2-S4) L=300mm
- S1 PNP = Toolholders clamped.
- S2 PNP = Piston under pressure ready to receive tools arbor.
- The electrosppindle can not turn.
- S4 PNP = Toolholders not clamped. The electrosppindle cannot turn.
- PT 100 bearing's temperature sensor
- 7-Front-side pressurization filtered (5µm) (1-1.5 bar) (G1/8")
- 8-Tool cooling (G1/2") (20 bar)
- 15-Outlet encoder's cables (Gel 2444 KN) L=300mm
- Motor thermal switch (N°1 PT 1000)
- 17-Tool's Lubro refrigerant inlet by rotary joint (G1/4") (max 80 bar)
- 18-Rotary joint leakage outlet (6 bar) (G1/8")
- 23-Outlet cables Montronix Spectra pulse

TOOL HOLDER HSK-A100 DIN 69893

SPEED	RPM	1700	8000
POWER (S1)	KW	53	53
TORQUE (S1)	Nm	307	63
TENSION (S1)	V	424 Max	
CURRENT	A	215 Max	

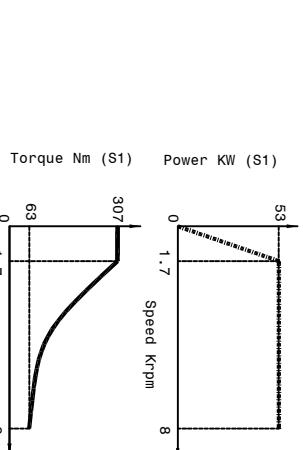
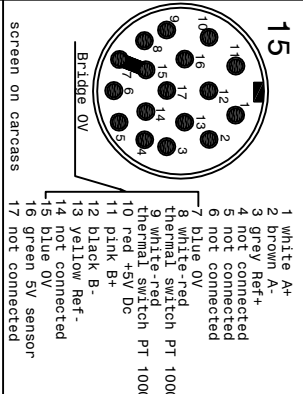

Synchronous motor: 12 poles
Runout taper: 0.002mm

Peron Speed CUSTOMER:
SUBJECT: PS TCV-219

