

517.5

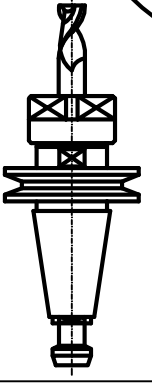

Tool holder ISO/BT 50

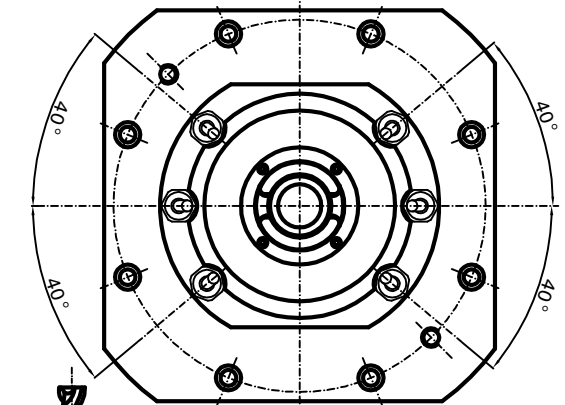
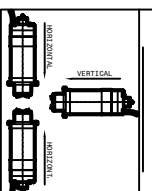
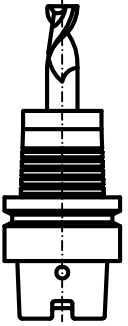

Tool holder HSK-A63  
DIN 69893

Coolant capacity=9650 Watt  
Air-oil Bearings Lubrication  
Mobil DTE Light ISO VG 32

- 1-Coolant inlet (3-4 bar) (7+8 L/min.)
- 2-Coolant outlet
- 3-Hydraulic pressure unclamping tool (min 80bar - max 90bar) (PT1/4")
- 5-Electric connection (L=1000)
- 3 Phases motor - Earth
- Phases U1/U3 n°2 cables Ø10
- Phases W1/W3 n°2 cables Ø10
- Earth n°2 cables Ø10
- 6-Outlet sensor's cables (S1-S2-S4-S5) (L=600mm)
- S1 PMP = Toolholders clamped Ø4
- S2 PMP = Piston under pressure ready to receive tools arbor Ø4
- S4 PMP = Toolholders not clamped Ø4
- S5 PMP = Sensor return piston Ø4
- The electrospindle cannot turn.
- 7-Front-side pressurization filtered (5µm) (1-1,5 bar) (Ø8,2)
- 8-Tool cooling water (Ø5) (20 bar)
- 9-Front bearings Lubrication -1 (PT1/8")
- 10-Front bearings Lubrication -2 (PT1/8")
- 11-Rear bearings Lubrication (PT1/8")
- 12-Unlocking lubrication bearings (PT1/8")
- 15-Outlet encoder's cables (Gel 2444 KN) (L=600mm)
- Motor thermal switch (N°1 Pt 1000)
- 17-Tool's Lubro refrigerant inlet by rotary(80 bar) joint(PT1/4")
- Inlet air arbor's cleaning (6 bar)
- 18-Rotary joint Leakage outlet (PT1/8")

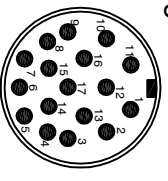

6

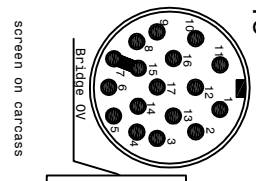

15

- 1 white A+
- 2 brown A-
- 3 grey Ref+
- 4 not connected
- 5 not connected
- 6 not connected
- 7 white-brown thermal switch PT 1000 (N°1 Pt 1000) DC
- 8 white-brown thermal switch PT 1000 (N°1 Pt 1000) DC
- 9 thermal switch PT 1000 (N°1 Pt 1000) DC
- 10 black B+
- 11 black B-
- 12 yellow Ref-
- 13 yellow Ref-
- 14 not connected
- 15 blue OV sensor
- 16 green SV sensor
- 17 not connected

REFRIGERANT	HPA	11000	12500	13500	16000	18000	19500	20500	22000	24000
ENERGY (kW)	50	55	60	65	70	75	80	85	90	95
FLOW (L/min)	8.6	21.5	30	49	62	62	62	62	62	62
TOUR (S1)	50	50	50	50	50	50	50	50	50	50
TENSION (S1)	V	57	122	160	276	380	380	380	380	380
CURRENT (S1)	A	200	200	200	190	154	117	100	98	98

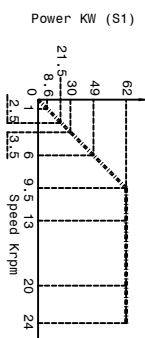
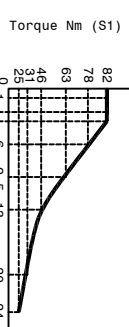

Choke = 0.3 mH/phase

Synchronous Motor: 6 poles  
Runout taper 0.002 mm

**Peron Speed**  
SUBJECT: PSI TCV-S-110  
CUSTOMER:

Sheet: 1/1  
DIS. N°5633-00-01  
DATE : 12/08/2022