

Tool Holder HSK-A63
DIN 69893

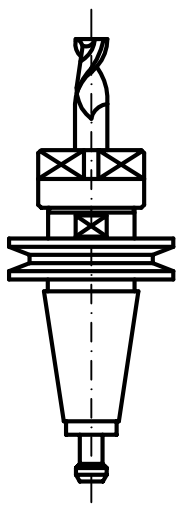

Tool holder ISO/BT 40

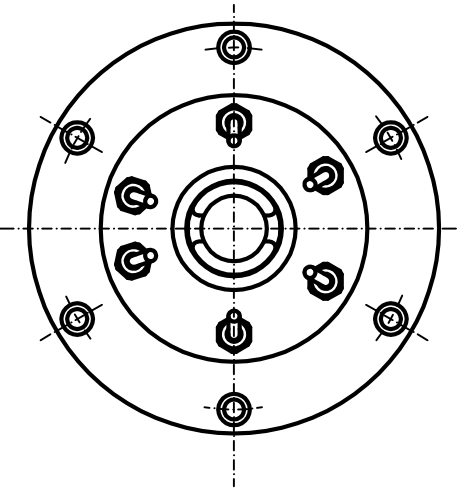
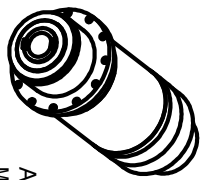
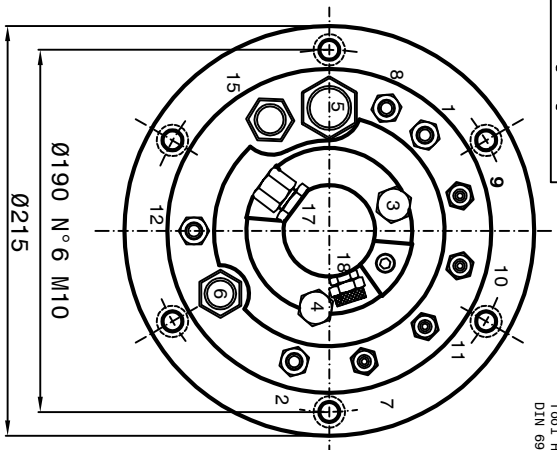
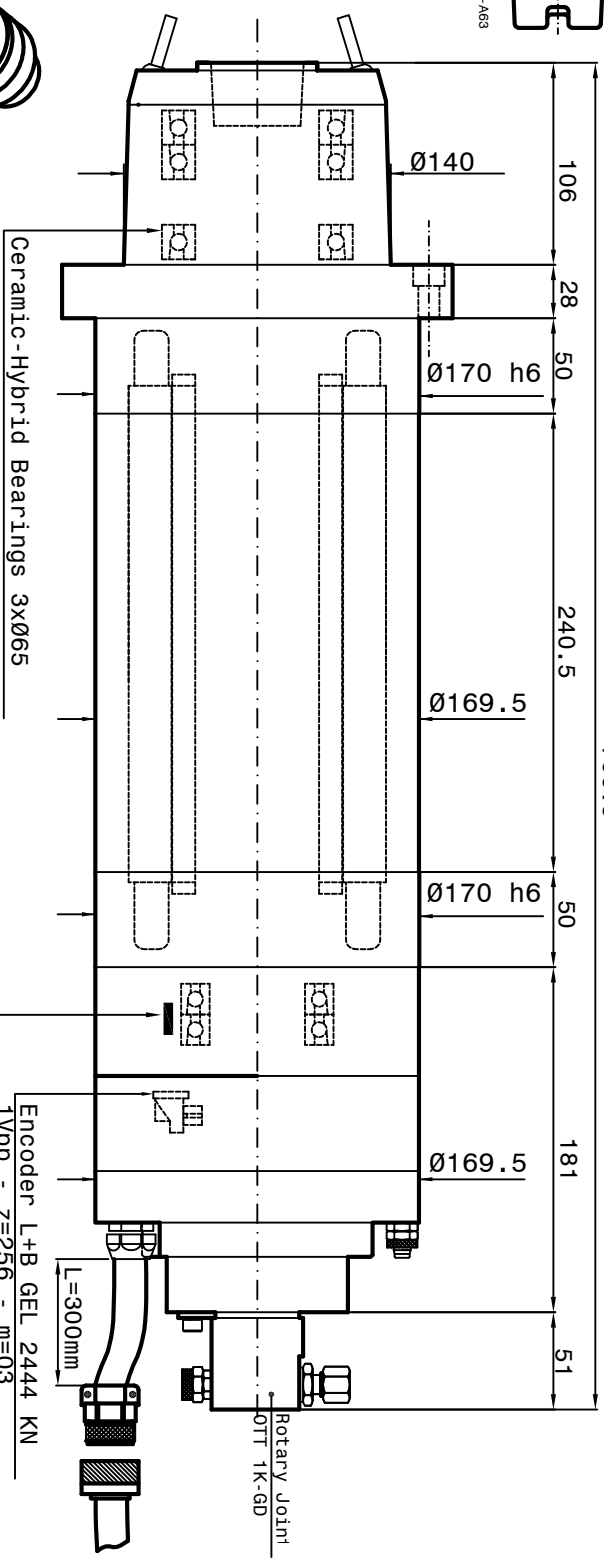

Air-Oil Bearings Lubrication
Mobil DTE Light ISO VG 32
Cooling capacity = 7150 Watt

- 1-Coolant inlet (G1/4")(3-4 bar)(8 L/min.)
- 2-Coolant outlet (G1/4")
- 3-Hydraulic pressure unclamping tool (min 80bar - max 90bar) (G1/4")
- 4-Hydraulic pressure clamping tool (Return piston)(10bar max) (G1/4")
- 5-Electric connection (L=300)
 - 3 Phases motor - Earth
- 6-Outlet sensor's cables (S1-S2-S4)(L=300mm)
 - S1 PNP = Toolholders clamped.
 - S2 PNP = Piston under pressure ready to receive tools arbor.
- The electrosprindle can not turn.
- S4 PNP = Toolholders not clamped
- The electrosprindle cannot turn.
- PT 100 Bearing's temperature sensor
- 7-Front-side pressurization filtered (5µm) (1-1.5 bar) (G1/8")
- 9-Front bearings Lubrication -1 (G1/8")
- 10-Front bearings Lubrication -2 (G1/8")
- 11-Rear bearings Lubrication (G1/8")
- 12-Unloadng Lubrication bearings (G1/8") through aspiration type Festo VAD 1/4
- 15-Outlet encoder's cables (Gel 2444 KN) Motor thermich switch (N°1 PT 1000)
- 17-Tool's Lubro refrigerant inlet by rotary joint(G1/4")(80 bar)
- 18-Rotary joint Leakage outlet (G1/8")

15

Bridge 0V

screen on carcass

- 1 white A+
- 2 brown A-
- 3 grey Ref+
- 4 not connected
- 5 not connected
- 6 not connected
- 7 blue 0V
- 8 white-red thermal switch PT 1000
- 9 white-red thermal switch PT 1000
- 10 red +5V Dc
- 11 pink B+
- 12 black B-
- 13 yellow Ref-
- 14 not connected
- 15 blue 0V
- 16 green 5V sensor
- 17 not connected

6

- 1 brown +24 V DC
- 2 blue 0 V DC
- 3 black S1 signal
- 4 black S2 signal
- 5 not connected
- 6 black S4 signal
- 7 not connected
- 8 not connected
- 9 not connected
- 10 PT 100
- 11 not connected
- 12 PT 100

5

- A not connected
- B blue phase V
- C black phase W
- D not connected
- E not connected
- F not connected
- G brown phase U
- H yellow-green Earth
- J not connected

SPEED	RPM	2000	16000	17500	18000	24000
FREQUENCY	Hz	107	307	381	900	1200
POWER (S1)	KW	12	35	38	38	25
TORQUE (S1)	Nm	57	48	20	10	
TENSION (S1)	V	110	305	380	390	380
CURRENT (S1)	A	98	98	89	78	54

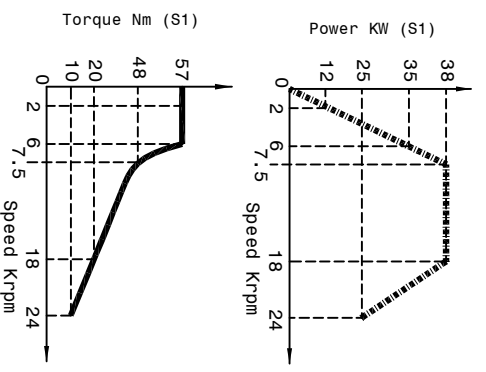

Motor Asynchronous: 6 poles Runout taper 0.002mm

Peron Speed INSTRUMENTS

SUBJECT: PSI TCV-119
CUSTOMER:

Sheet: 1/1 | D/S: N°2091-00 | DATE : 11/08/2022