

Tool Holder HSK-A63
DIN 69893

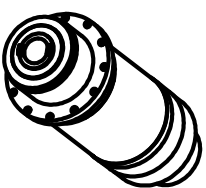

Cooling capacity = 4150 Watt
Grease Bearings Lubrication

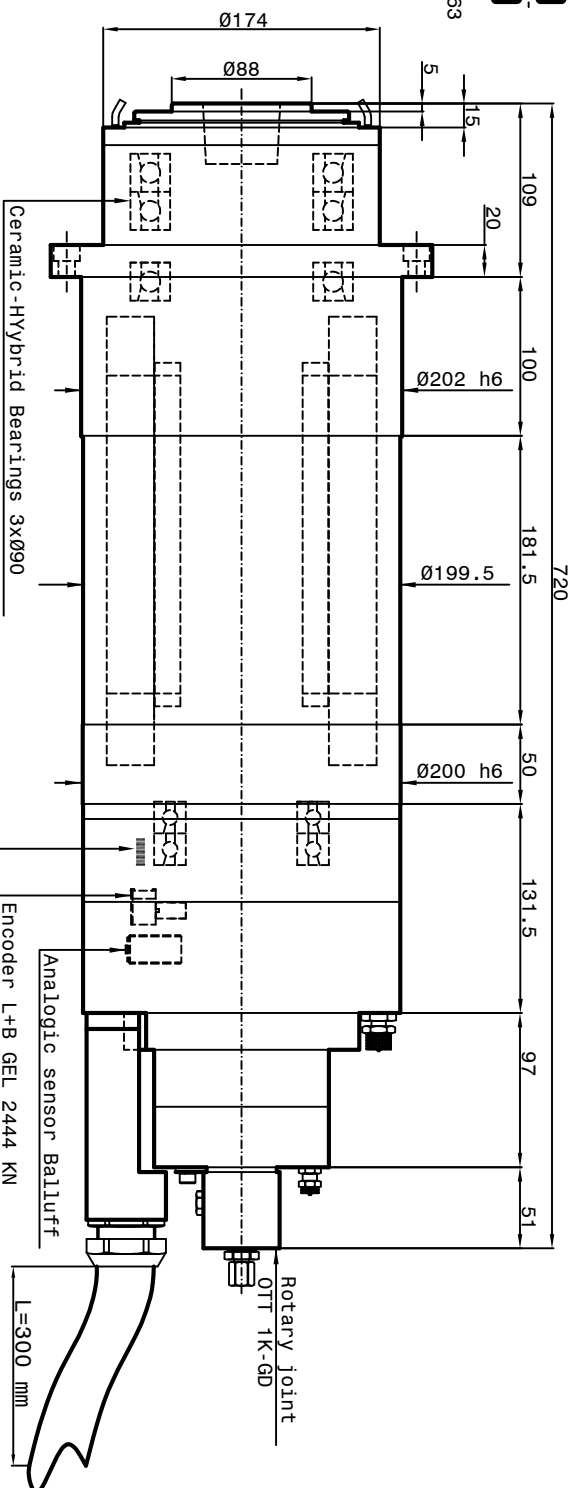
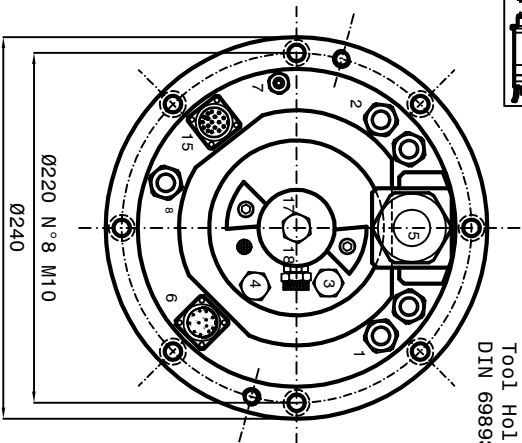
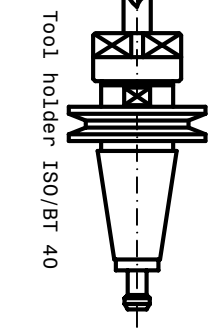
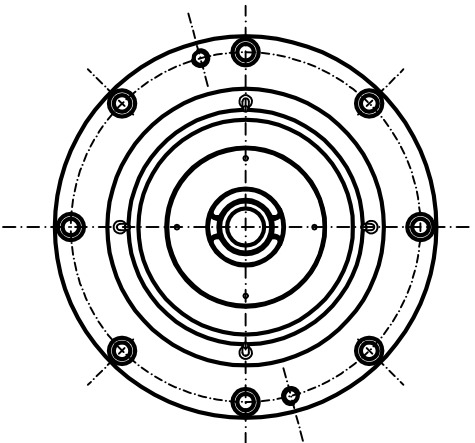

Tool holder ISO/BT 40

- 1-Coolant inlet (G3/8") (3+4 bar) (10 L/min.)
- 2-Coolant outlet (G3/8")
- 3-Hydraulic pressure unclamping tool (50bar min.,90 bar max) (G1/4")
- 4-Hydraulic pressure clamping tool (return piston) (10bar max) (G1/4")
- 5-Electric connection L=300 mm 3phases motor - Earth
- 6-Outlet sensor cables (S6)
S6 = Analogic Sensor
Themich sensor bearings PT 100
- 7-Front-side pressurization filtered (5µm) (1-1.5 bar) (G1/8")
- 8-Tool cooling (G3/8")
- 15-Outlet encoder's cables (Gel 2444 KN)
Motor thermich switch (N°1 PT 1000)
- 17-Tool's Lubro. refrigerant Inlet by rotary joint (G1/4") (80bar max)
- Inlet air arbor's cleaning (6 bar)
The electrospindle can not turn.
- Inlet air rotary joint (10 bar max)
- 18-Rotary joint leakage outlet (G1/8")

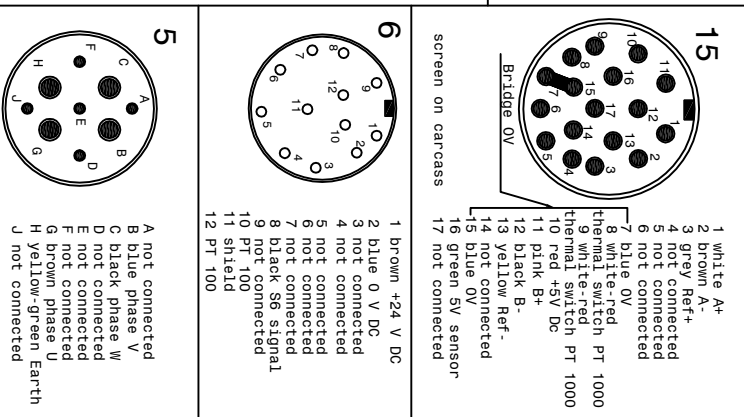

SPEED	RPM	3000	6750	8450	12000
FREQUENCY	Hz	104	229	285	400
POWER (S1)	KW	25.1	56.5	56.5	56.5
TORQUE (S1)	Nm	80	80	64	45
TENSION (S1)	V	144	305	380	380
CURRENT (S1)	A	139	139	116	101
POWER (S6-40% 2 min.)	KW	32.6	74	74	74
TORQUE (S6-40% 2 min.)	Nm	105	105	83.9	59.1
TENSION (S6-40% 2 min.)	V	144	305	380	380
CURRENT (S6-40% 2 min.)	A	174	173	144	131

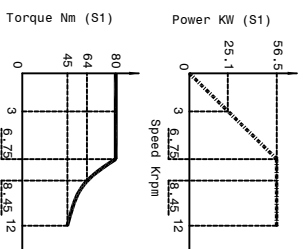

Asynchronous Motor: 4 poles
Runout taper 0.002mm

Peron Speed
INTERMOTOR

SUBJECT: PSI TCV-202
CUSTOMER:

Sheet: 1/1
DIS. N°5642-00
DATE : 10/08/2022