

Tool holder ISO/MT 50

Tool holder HSK-A100  
DIN 69893

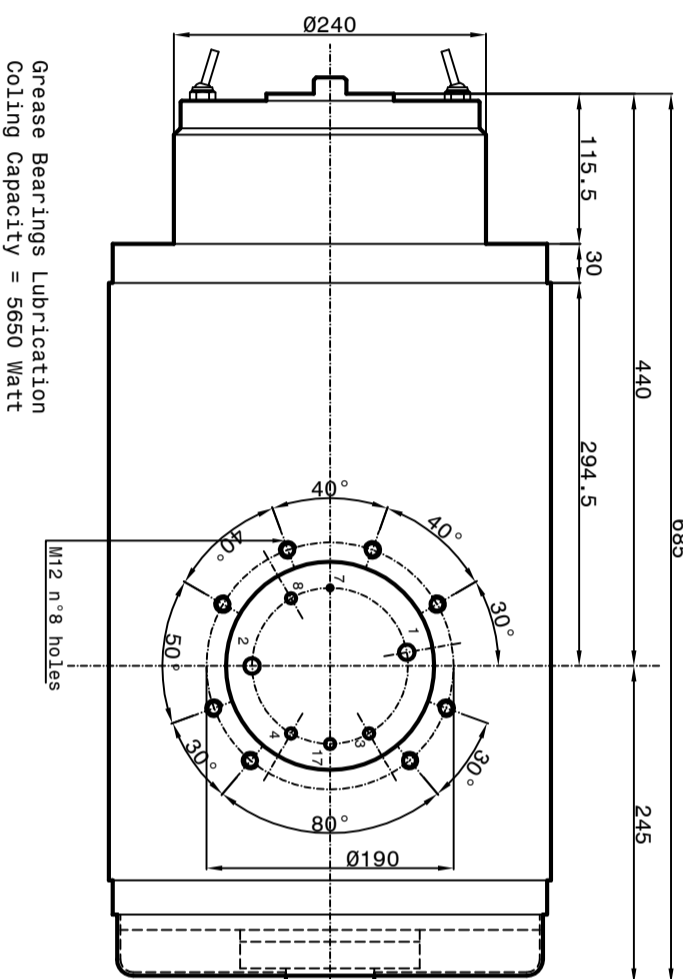

Grease Bearings Lubrication  
Cooling Capacity = 5650 Watt

- 1-Coolant inlet (Ø12)(3-4 bar)(12\*13 L/min.)
- 2-Coolant outlet (Ø12)
- 3-Hydraulic pressure unclamping tool (min 80bar - max 90bar) (Ø8)
- 4-Hydraulic pressure clamping tool (Return piston) (10bar max) (Ø8)
- 5-Electric connection (L=2000)
- 3 Phases motor - Earth
- Phase U n°2 wires Ø6
- Phase V n°2 wires Ø6
- Phase W n°2 wires Ø6
- Earth n°2 wires Ø6
- Outlet sensor's cables (S1-S2-S4) (L=2000mm)
- S1 PMP = Toolholders clamped Ø4
- S2 PMP = Piston under pressure ready to receive tools arbor Ø4
- The electrosprindle can not turn.
- S4 PMP = Toolholders not clamped Ø4
- The electrosprindle cannot turn.
- PT 100 Bearing's temperature sensor
- Outlet encoder's cables (Gel 2444 KN) (L=2000mm)
- Motor thermal switch (N°1 PT 1000)
- 7-Front-side pressurization filtered (5µm) (1-1.5 bar) (Ø4)
- 8-Tool cooling water (Ø8) (20 bar)
- 17-Tool's Lubro refrigerant inlet by rotary(80 bar) joint(Ø6)
- Inlet air arbor's cleaning (6 bar) joint(Ø6)
- 18-Rotary joint leakage outlet (Ø1/8")

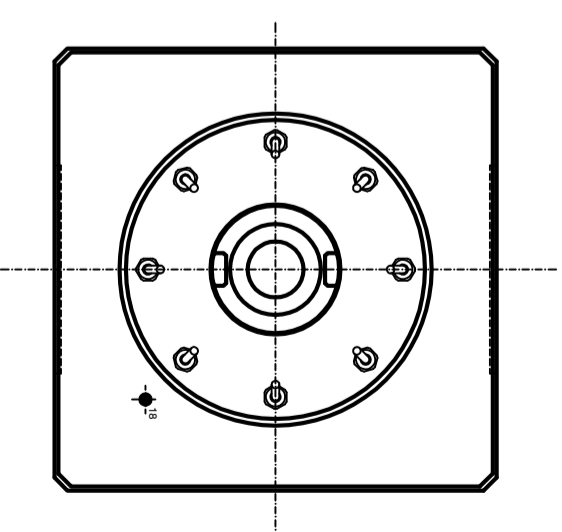

SPEED	RPM	1000	2000	3000
FREQUENCY	Hz	70	133	533
POWER (S1)	Kw	36	36	36
TORQUE (S1)	Nm	340	173	45
TENSION (S1)	V	200	380	380
CURRENT (S1)	A	148	105	68
POWER (S6-40% 2 min.)	Kw	45	45	45
TORQUE (S6-40% 2 min.)	Nm	430	217	47
TENSION (S6-40% 2 min.)	V	200	380	380
CURRENT (S6-40% 2 min.)	A	180	115	74

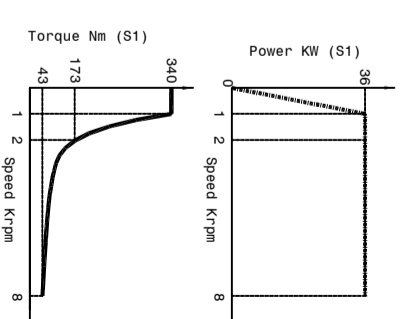

Asynchronous Motor: 8 poles  
Runout taper 0.002mm

**Peron Speed**  
INTERMOTOW

SUBJECT: PSI ES-302  
CUSTOMER:

Sheet: 1/1 DIS.N°3962-00

DATE: