

Grease Bearings Lubrication
Coolant Capacity = 4250 Watt

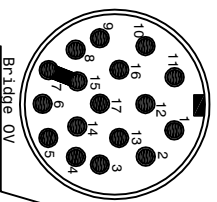

- 15**
- 1 white A+
 - 2 brown A-
 - 3 grey Ref+
 - 4 not connected
 - 5 not connected
 - 6 not connected
 - 7 blue 0V
 - 8 white-brown thermal switch PT 1000
 - 9 white-brown thermal switch PT 1000
 - 10 red +5V DC
 - 11 pink B+
 - 12 black B-
 - 13 yellow Ref-
 - 14 not connected
 - 15 blue 0V
 - 16 green 5V sensor
 - 17 not connected
- screen on carcass

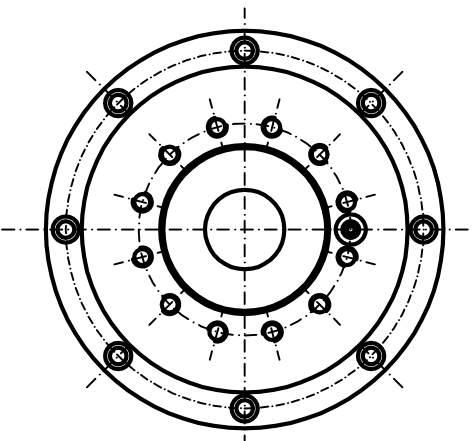
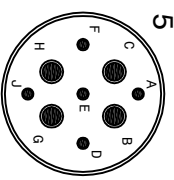

- 5**
- A not connected
 - B blue phase V
 - C black phase W
 - D thermal switch PTC 130
 - E not connected
 - F thermal switch PTC 130
 - G brown phase U
 - H yellow-green Earth
 - J not connected

- 1-Coolant inlet (G1/4") (3-4 bar) (5+6 L/min.)
- 2-Coolant outlet (G1/4")
- 5-Electric connection
- 3 Phases motor - Earth
- 7-Front-side pressurization filtered (5µm) (1-1.5 bar) (G1/8")
- 15-Outlet encoder's cables (Gel 2444 KN) -motor thermal switch (N°1 PT 1000)

SPEED	RPM	1000	2000	2500	2800	5000
FREQUENCY	Hz	75	145	173	196	334
POWER (S1)	KW	11.5	23.5	29	29	334
TORQUE (S1)	Nm	110	110	110	97	57
TENSION	V	150	285	335	380	380
CURRENT	A	80	80	80	73	60

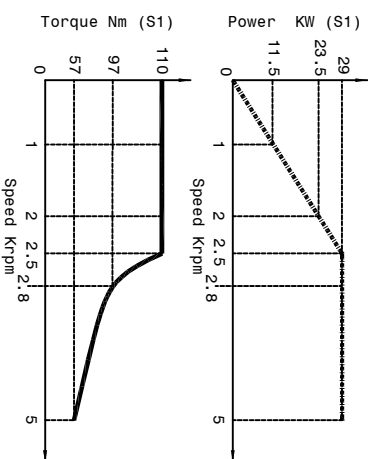

Asynchronous motor: 8 Poles Runout taper 0.002mm

Peron Speed
INTELLIGENT

SUBJECT: PSI TA-101
ASA 6
CUSTOMER :

Sheet: 1/1

Dis. n° 2436-00-03

DATE : 02/07/2021