

Tool Holder HSK-A63
DIN 69893

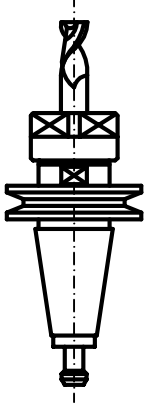

Tool holder ISO/BT 40

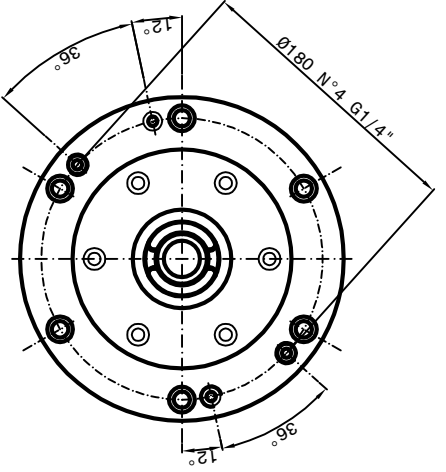
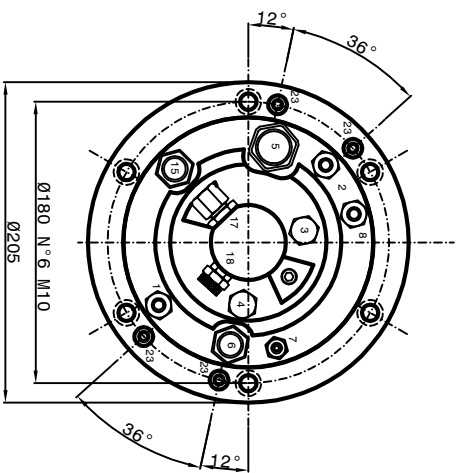
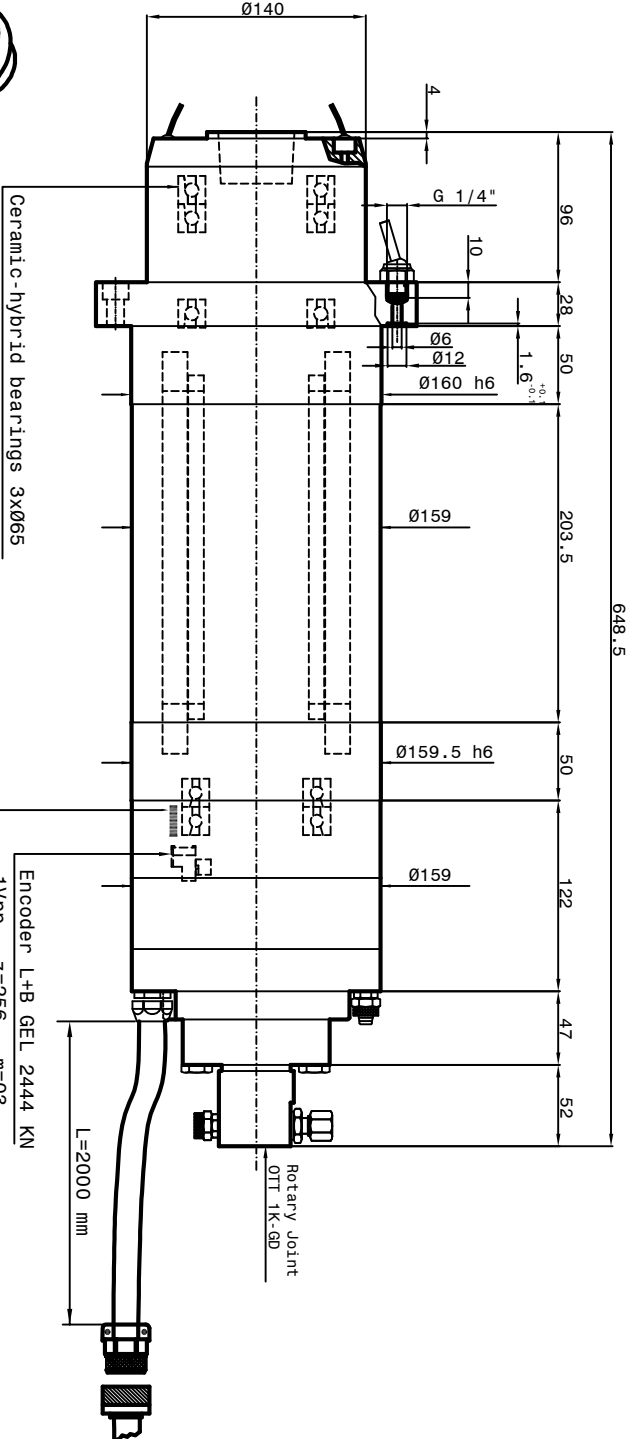
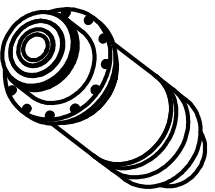

Grease Bearings Lubrication
Cooling capacity = 3550 Watt

- 1-Coolant inlet (G1/8") (3-4 bar) (4+5 L/min.)
- 2-Coolant outlet (G1/8")
- 3-Hydraulic pressure unclamping tool (min 80bar - max 90bar) (G1/4")
- 4-Hydraulic pressure clamping tool (Return piston) (10bar max) (G1/4")
- 5-Electric connection (L=300)
- 3 Phases motor - Earth
- 6-outlet sensor's cables (S1-S2-s4) (L=300mm)
- S1 PNP = Toolholders clamped.
- S2 PNP = Piston under pressure ready to receive tools arbor.
- The electrospindle can not turn.
- S4 PNP = Toolholders not clamped. The electrospindle cannot turn.
- PT 100 Bearing's temperature sensor
- 7-Front-side pressurization filtered (5µm) (1-1.5 bar) (G1/8")
- 8-Tool cooling water (G1/4") (20 bar)
- 15-Outlet encoder's cables (Gel 2444 KN) Motor thermostat switch (N°1 PT 1000)
- 17-Tool's Lubro refrigerant Inlet by rotary (80 bar) joint (G1/4")
- Inlet air arbor's cleaning (6 bar)
- 18-Rotary joint leakage outlet (G1/8")
- 23-Tool cooling (G 1/4")

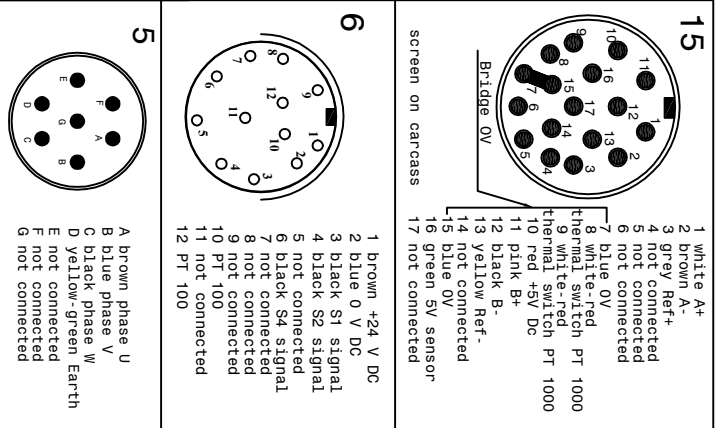

SPEED	RPM	500	1000	2000	6000	9000	15000
FREQUENCY	Hz	31	60	110	313	449	900
POWER (S1)	KW	1.8	3.7	7.25	22	22	22
TORQUE (S1)	Nm	34	34	34	24	24	12
CURRENT	A	38	58	93	265	380	380
POWER (S6/40%-2 min)	V	75	72	70	54	47	22
TORQUE (S6/40%-2 min)	Nm	43	43	43	30	13.5	13.5
TENSION (S6/40%-2 min)	V	38	58	93	265	380	380
CURRENT (S6/40%-2 min)	A	89	84	84	62	54	54

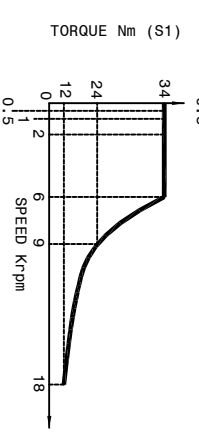
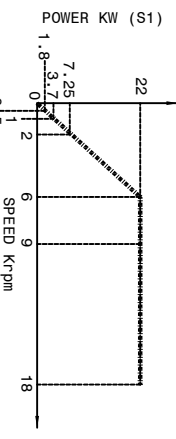

Asynchronous Motor: 6 pole
Runout taper 0.002r

Peron Speed
SUBJECT: P-SI TCV-114-SP
CUSTOMER:

Sheet: 1/1
Dts. n°1841-00-07
DATE: 11/08/2022