

Tool Holder HSK-A63
DIN 69893

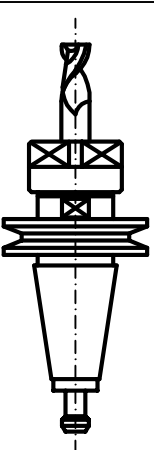

Tool holder ISO/BT 40

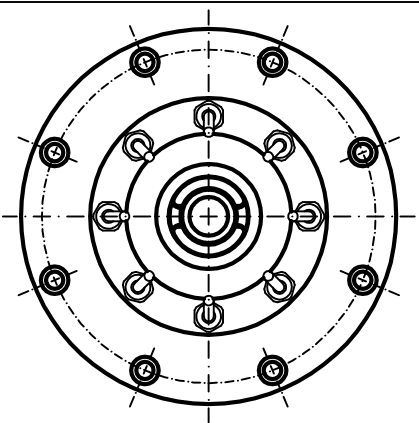
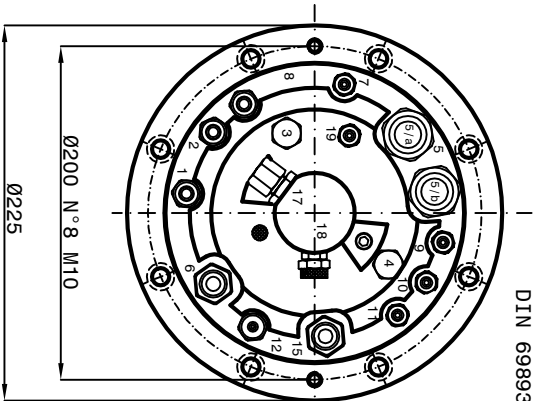
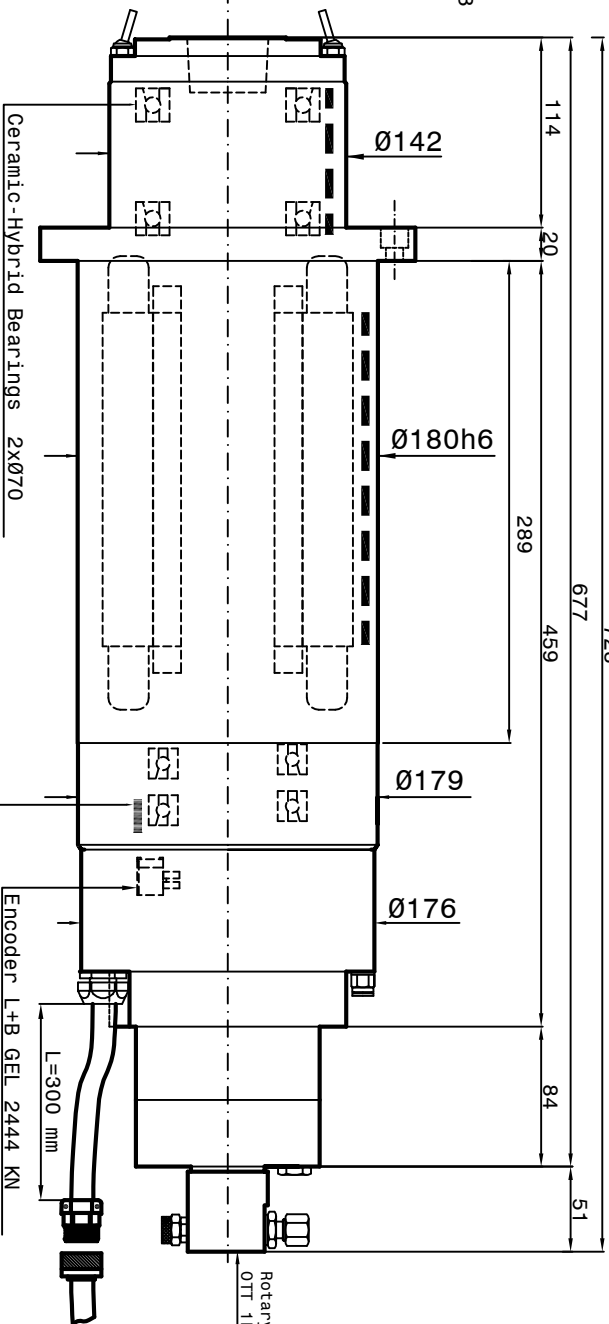

Cooling capacity = 3550 Watt
Air-Oil bearings Lubrication
Mobil DTE Light ISO VG 32

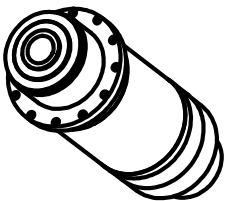

- 1-Coolant inlet (G1/4") (5+6 l/min.) (3-4 bar)
- 2-Coolant outlet (G1/4")
- 3-Hydraulic pressure unclamping tool (min 80bar - max 90bar) (G1/4")
- 4-Hydraulic pressure clamping tool (Return piston) (10bar max) (G1/4")
- 5-Electric connection (L=300)
- 3 Phases motor - Earth
- 5/a Phases U1/U3-V1/V3 n°4 cables Ø6
- 5/b Phases W1/W3-Earth n°4 cables Ø6
- 6-Outlet sensor's cables (S6) (L=300mm)
S6 = Analogic sensor Balluff
- PT 100 Bearing's temperature sensor
- 7-Front-side pressurization filtered (5µm) (1-1.5 bar) (G1/8")
- 8-Tool cooling water (G1/4") (20 bar)
- 9-Front bearings Lubrication -1 (G1/8")
- 10-Front bearings Lubrication -2 (G1/8")
- 11-Rear bearings Lubrication (G1/8")
- 12-Unloading Lubrication bearings (G1/4") through aspiration type Festo VAD 1/4 (6 bar)
- 15-Outlet encoder's cables (GEL 2444 KN) (L=300mm)
- Motor thermal switch (N°1 PT 1000) joint (G1/4")
- 17-Tool's Lubro refrigerant inlet by rotary (80 bar)
- 18-Rotary joint leakage outlet (G1/8")
- 19-Inlet air arbor's cleaning (G1/8") (6 bar)

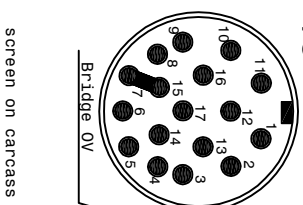

15

- 1 white A+
- 2 brown A-
- 3 grey Ref+
- 4 not connected
- 5 not connected
- 6 not connected
- 7 blue OV
- 8 white-red thermal switch PT1000
- 9 white-red thermal switch PT1000
- 10 red +5V Dc
- 11 pink B+
- 12 black B-
- 13 yellow Ref-
- 14 not connected
- 15 blue OV
- 16 green 5V sensor
- 17 not connected

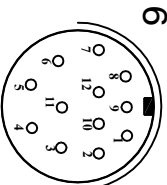

6

screen on carcass

- 1 brown +24 V DC
- 2 blue 0 V DC
- 3 not connected
- 4 not connected
- 5 not connected
- 6 not connected
- 7 not connected
- 8 black S6 signal
- 9 not connected
- 10 PT 100
- 11 shield
- 12 PT 100

SPEED	1200	2100	3720	6000	10000	18000	24000
FREQUENCY	Hz	60	106	185	300	500	900
POWER (S1)	KW	7	12	22	22	22	22
TORQUE (S1)	Nm	57	57	57	34	21	12
TENSION (S1)	V	82	130	232	380	380	380
CURRENT (S1)	A	32	80	80	62	51	48.5
POWER (56-60% 2 m.l.n.)	KW	8	13.5	25	25	23	23
TORQUE (56-60% 2 m.l.n.)	Nm	65	65	39	22	12.4	9
TENSION (56-60% 2 m.l.n.)	V	82	130	232	380	380	380
CURRENT (56-60% 2 m.l.n.)	A	91	89	89	65	54	51

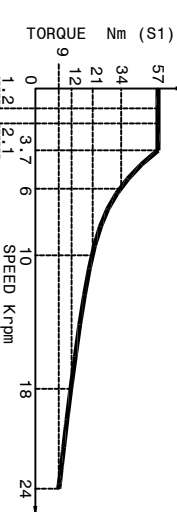
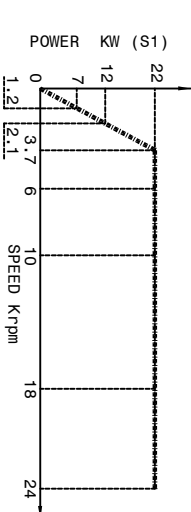

Asynchronous Motor: 6 pole
Runout taper 0.002m

Peron Speed
INSTRUMENTAL
SUBJECT: PSI TCV-124-SP
CUSTOMER: