

Tool Holder HSK-A100
B type DIN 69893

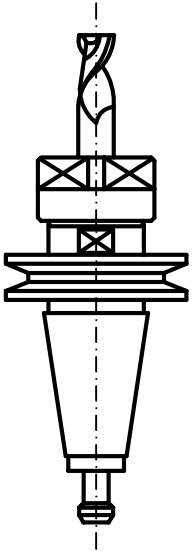

Tool holder ISO/BT 50

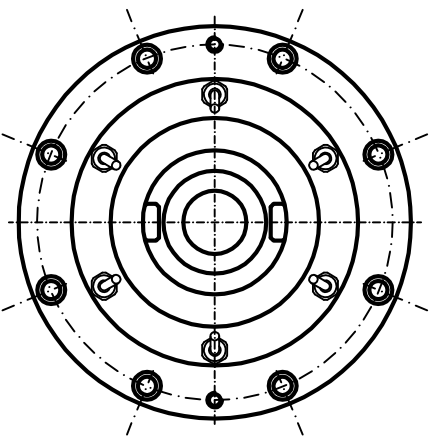
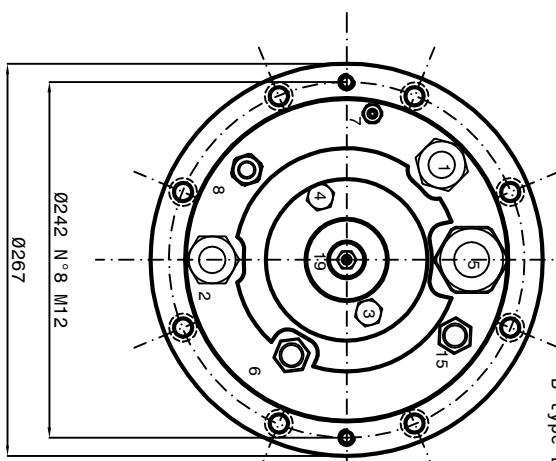
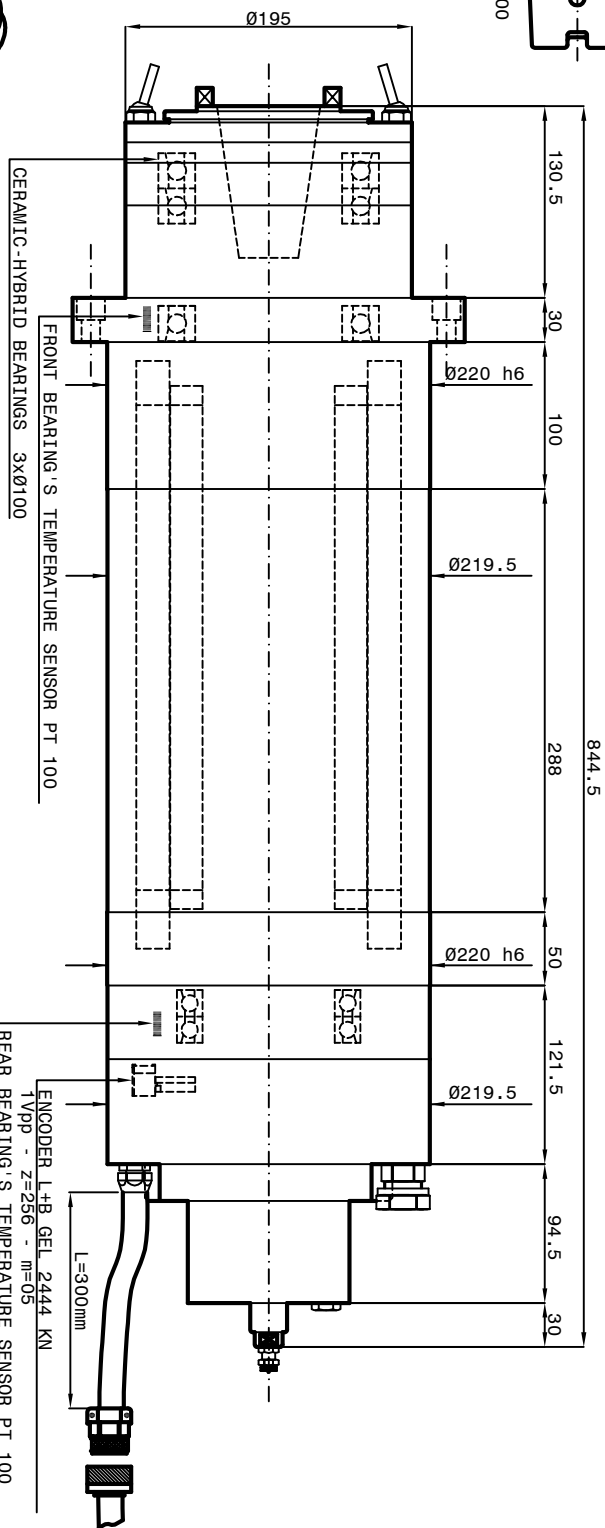

**Coolant capacity = 6250 Watt
Grease Bearings Lubrication**

- 1-Coolant inlet (G1/2") (16 l/min) (-3-4 bar)
- 2-Coolant outlet (G1/2")
- 3-Hydraulic pressure unclamping tool (min 80bar - max 90bar) (G1/4")
- 4-Hydraulic pressure clamping tool (Return piston) (10bar max) (G1/4")
- 5-Electric connection (L=300) no connector
- 6/Phases motor - Earth
- Phase V1/V3 Ø 8 n° 2 cables 2x10mm²
- Phase W1/W3 Ø 8 n° 2 cables 2x10mm²
- Phase U1/U3 Ø 8 n° 2 cables 2x10mm²
- Earth Ø 8 n° 2 cables 2x10mm²
- 6-Outlet sensor's cables (S1-S2-S4) (L=300mm)
- S1 PNP = Toolholders clamped.
- S2 PNP = Piston under pressure ready to receive tools arbor.
- The electrospindle can not turn.
- S4 PNP = Toolholders not clamped. The electrospindle cannot turn.
- PT 100 Bearing's temperature sensor
- 7-Front-side pressurization filtered (5µ)
- (1-1.5 bar) (G1/8")
- 8-Tool cooling water (G3/8") (20 bar)
- 15-Outlet encoder's cables (Gel 2444 KN) (L=300mm)
- Motor thermal switch (N°1 PT 1000)
- 19-Inlet air arbor's cleaning (G1/8") (6 bar)

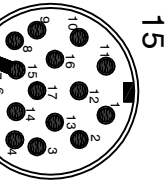

- 1 white A+
- 2 brown A-
- 3 grey Ref+
- 4 not connected
- 5 not connected
- 6 not connected
- 7 blue 0V
- 8 white-red thermal switch PT 1000
- 9 red +5V Dc thermal switch PT 1000
- 10 red +5V Dc
- 11 pink B+
- 12 black B-
- 13 yellow Ref-
- 14 not connected
- 15 blue 0V
- 16 green 5V sensor
- 17 not connected

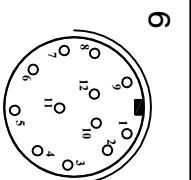

- 1 brown +24 V Dc
- 2 blue 0 V Dc
- 3 black S1 signal
- 4 black S2 signal
- 5 not connected
- 6 black S4 signal
- 7 rear PT 100
- 8 not connected
- 9 rear PT 100
- 10 front PT 100
- 11 shield
- 12 front PT 100

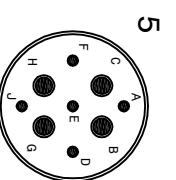

- A not connected
- B blue phase V
- C black phase W
- D not connected
- E not connected
- F not connected
- G brown phase U
- H yellow-green Earth
- J not connected

Motor ATE AC 180/330/8 No 160 0516 100

SPEED	RPM	1000	2000	2600	7000	12000
FREQUENCY	Hz	70	130	180	490	800
POWER (S1)	KW	21	40	40	40	40
TORQUE (S1)	Nm	200	200	143	53	32
TENSION	V	148	275	380	380	380
CURRENT	A	122	119	97	78	53

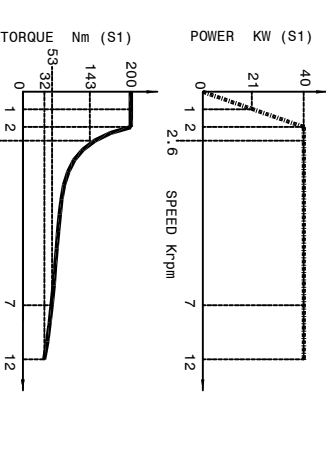

Asynchronous Motor: 8 pole Runout taper 0.002mm

Peron Speed
SUBJECT: PSI TCV-207
CUSTOMER:

Sheet: 1/1 Dts: n°3541-00-01 DATE: 09/08/2022