

TOOL HOLDER HSK-A63/100
DIN 69893

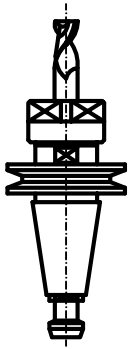

Tool holder ISO/BT 40/50

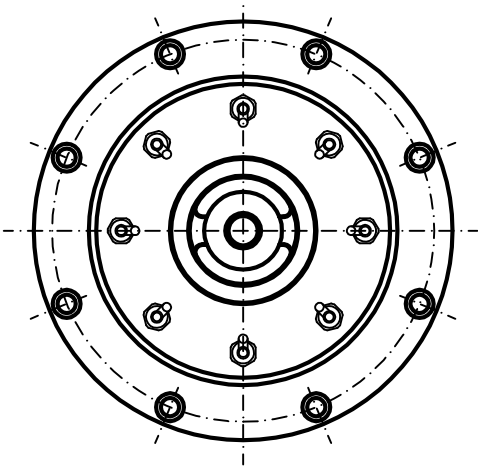
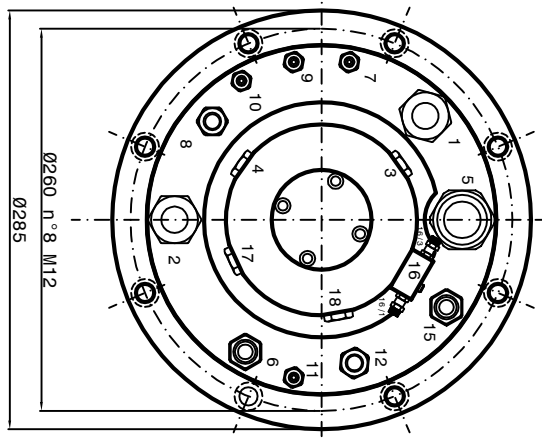
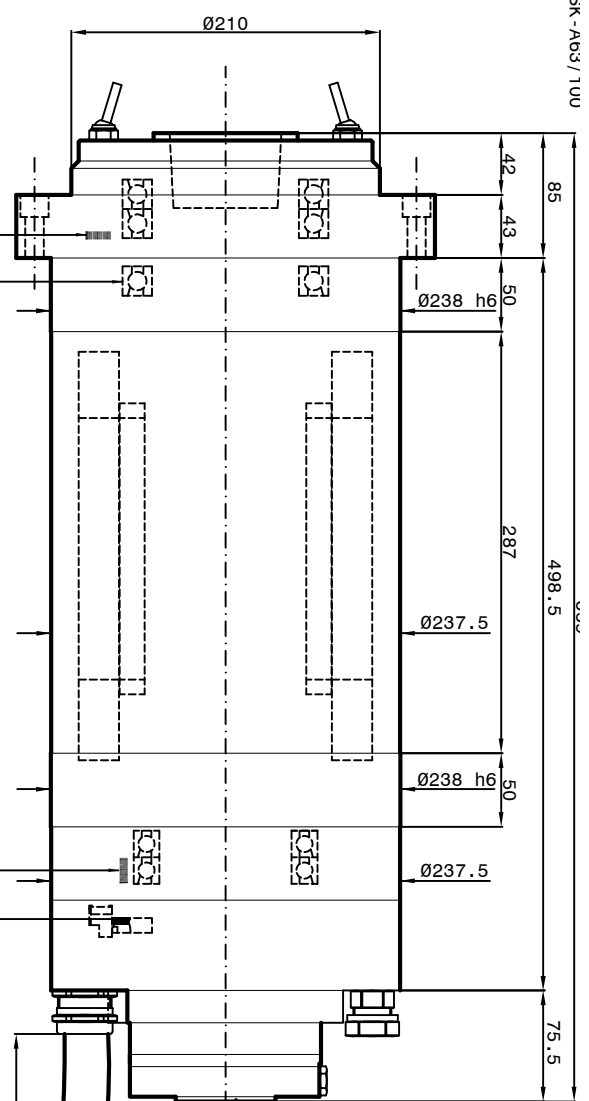

Coolant capacity = 6250 Watt
Air-Oil Bearings Lubrication

- 1-Coolant inlet (G1/2") (3-4 bar) (16 l/min.)
- 2-Coolant outlet (G1/2")
- 3-Hydraulic pressure clamping tool (return piston) (10bar max) (G1/4")
- 4-Hydraulic pressure unclamping tool (90bar max) (G1/4")
- 5-Electric connection (L=300mm) 3 Phases motor - Earth
- 6-outlet sensor's cables (S1-S2-S4) (L=300mm)
S1 = Toolholders clamped.
S2 = Piston under pressure ready to receive tools arbor.
The electrospindle can not turn.
S4 = Toolholders not clamped.
The electrospindle cannot turn.
- PT 100 Bearing's temperature sensor
- 7-Front-side pressurization (G1/8")
- 8-Tool cooling (G3/8") (20 bar)
- 9-Front bearings Lubrication 1 (G1/8")
- 10-Front bearings Lubrication 2 (G1/8")
- 11-Rear bearings Lubrication 1 (G1/8")
- 12-unloading Lubrication bearings (G1/8") through application type Festo VAD 1/8 (6 bar)
- 15-outlet encoder's cables (Gel 2444 KN) (L=300mm)
- Motor thermal switch (N°1 PT 1000)
- 17-Tool's Lubro refrigerant inlet by rotary joint (80 bar) (G1/4")
-Inlet air arbor's cleaning (6 bar)
-The electrospindle cannot turn.
-Inlet air 5 bar 10000 RPM
- MOL
- 18-Rotary joint leakage outlet (G1/8")

CERAMIC-HYBRID BEARINGS 3xØ100
PT 100 FRONT BEARING'S TEMPERATURE SENSOR

ENCODER L+B GEL 2442 KN
1Vpp - Z=512 - m=03
PT 100 REAR BEARING'S TEMPERATURE SENSOR



ROTARY JOINT
OTT 1K-GDK

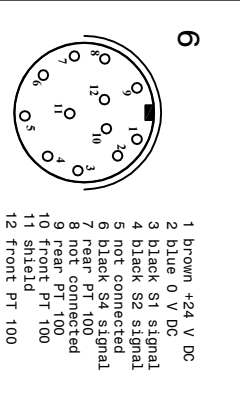
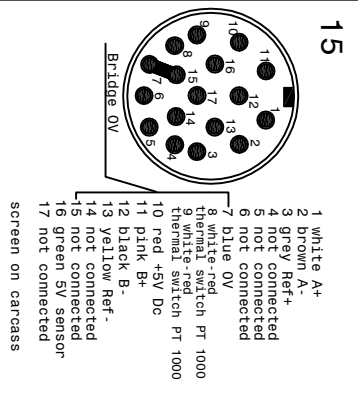

SPEED	Rpm	1000	1300	1500	1800	2000
FREQUENCY	Hz	67	88	294	600	800
POWER (S1)	Kw	30	40	40	40	30
TORQUE (S1)	Nm	289	289	86	42	24
TENSION (S1)	V	149	187	420	420	420
CURRENT (S1)	A	199	199	61	88	92

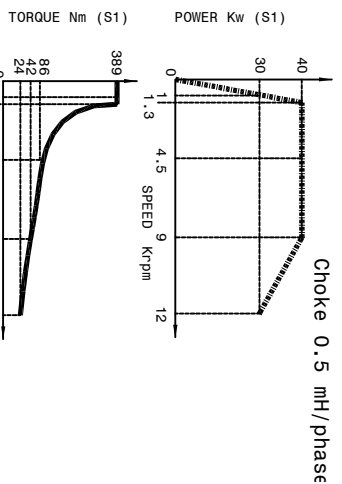

Synchronous motor: 8 poles
Runout taper: 0.002mm

Peron Speed
INSTRUMENTAL

SUBJECT: PS TCV-211
CUSTOMER: