

Ceramic-Hybrid Bearings 4xØ130

PT 100 Bearings Temperature Sensor

Analogic Sensor Balluff

Rotary Joint
OTT 1K-GDK-44

Encoder L+B GEL 2444-KN

M16 n°4 holes

SPEED	RPM	1000	2000	3000	3500
POWER (S1)	KW	89	89	89	89
TORQUE (S1)	Nm	849	424	283	242
TENSION (S1)	V			453 Max	
CURRENT (S1)	A			126 max	

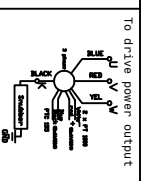

Tool Holder HSK-A100
DIN 69893

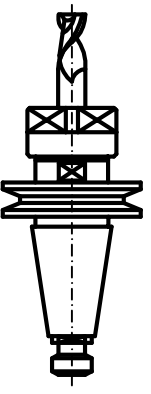

Tool Holder ISO/BT 50

Cooling capacity = 7950 Watt
Grease Bearings Lubrication

- Coolant inlet (G1/2") (3-4 bar) (16 L/min.)
- Coolant outlet (G1/2")
- Hydraulic pressure unclamping tool (min 80bar - max 90bar) (G1/4")
- Hydraulic pressure clamping tool (Return piston) (10bar max) (G1/4")
- Electric connection (L=800)
 - 3 Phases motor - Earth
 - 5/a Phase V - Earth
 - 5/b Phase W
 - 5/b Phase U
- Outlet sensor's cables (S6) (L=800mm)
 - S6 = Analogic sensor Balluff
- PT 100 Bearing's temperature sensor
- Front-side pressurization filtered (5µm) (1-1.5 bar) (G1/8")
- Tool cooling water (G1/2") (20 bar)
- Outlet encoder's cables (Gel 2444 KN) (L=800mm)
 - Motor thermal switch (N°1 PT 1000)
- Tool's Lubro refrigerant inlet by rotary joint (G1/4")
 - Inlet air arbor's cleaning (6 bar)
 - Rotary joint leakage outlet (G1/8")

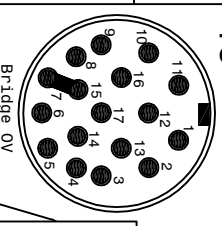

15

6

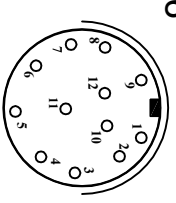

- White A+
- Brown A-
- grey Ref+
- not connected
- not connected
- not connected
- blue OV
- white-red thermal switch PT 1000
- white-red thermal switch PT 1000
- red +5V Dc
- pink B+
- black B-
- yellow Ref-
- not connected
- blue OV
- green 5V sensor
- not connected

screen on carcass

Synchronous motor: 16 poles

Runout taper 0.002mm

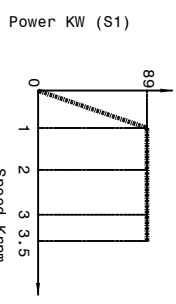
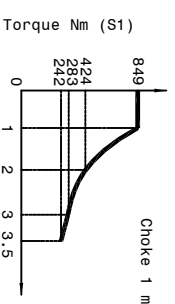

Peron Speed
INTERMEDIATE

SUBJECT: PSI TCV-304
CUSTOMER:

Sheet: 1/1

DIS. N° 4155-00

DATE: 08/08/2022