

Cooling capacity = 10550 Watt
Grease Bearings Lubrication

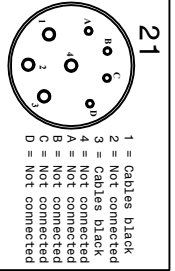

Motor: Synchronous
Power : 63.5 kW
Torque : 1243 Nm
Speed Max1 = 6000 RPM

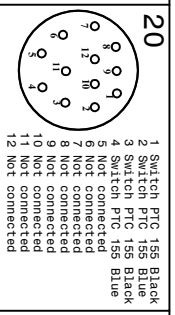
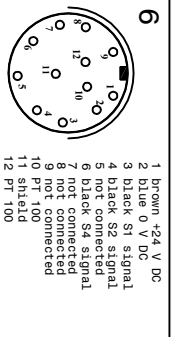
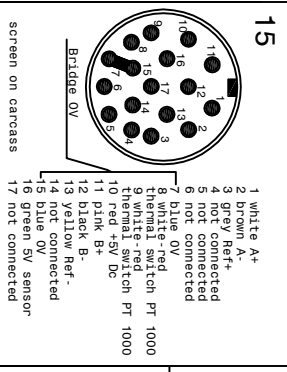
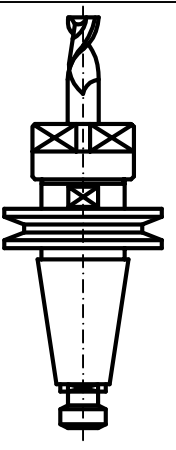
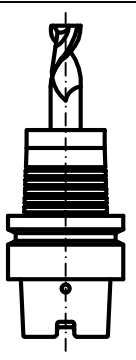

- Coolant inlet (G1/2") (3±4 bar) (21l/min.)
- Coolant outlet (G1/2")
- Hydraulic pressure return piston (15bar min.-50bar max) (G1/4")
- Hydraulic pressure unclamping tool (52bar min.-70bar max) (G1/4")
- Electric connection L=1mt.
- 5-a-2-phase motor Ø8 - 2earth Ø10
- 5-b-2-phase motor Ø8
- 5-c-2-phase motor Ø8
- Outlet sensor's cables (S1-S2-S4)
- Toolholders clamped. S1 = Piston under pressure. S2 = To receive toolholders. S4 = The electrospindle can not turn.
- Toolholders not clamped. The electrospindle cannot turn. PT 100 bearing's temperature sensor
- Front-side pressurization filtered (5µm) (1-1.5 bar) (G1/8")
- Tool cooling (G1/2") (12 l/min.) (1-1.5 bar) (G1/8")
- Outlet encoder's cables (Gal 2444 KN) Motor thermal switch (N°1 PT 1000) by rotary joint(G1/4")
- Tool's Lubro refrigerant inlet(80 bar)
- Inlet air arbor's cleaning(6 bar)
- Outlet cables PTC (n°4)
- Outlet cables Black (n°2)

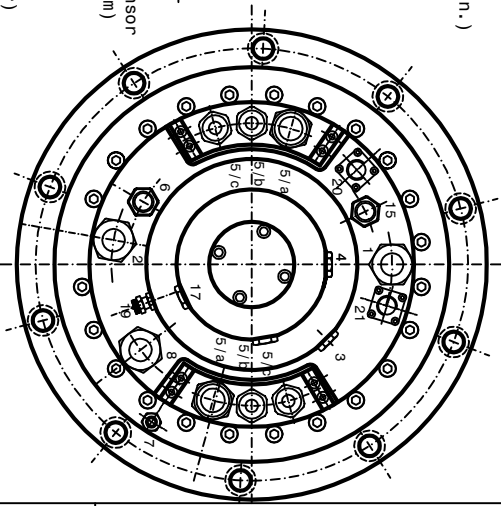

SPEED	RPM	1000	16000
POWER (S1)	KW	63.5	63.5
TORQUE (S1)	Nm	1243	101
TENSION (S1)	V	453	Max
CURRENT (S1)	A	126	max

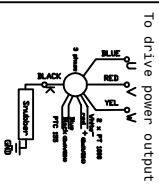
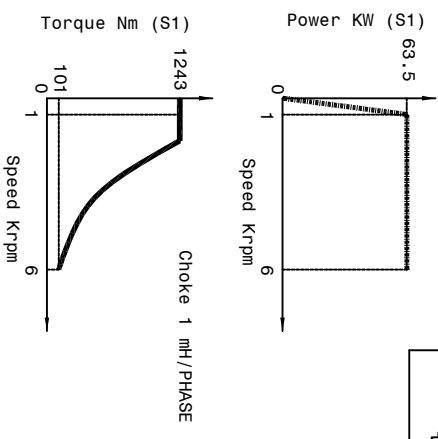

Synchronous motor: 16 poles Runout taper 0.002mm

Person Speed
INTERVAL

SUBJECT: PSI TCV-306
CUSTOMER:

Sheet: 1/1 DIS. N° 2525-00 DATE: 08/08/2022