

### Grease Bearings Lubrication

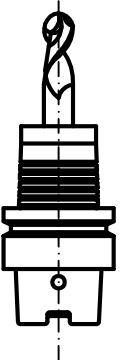

Tool holder HSK C 50  
DIN 69893

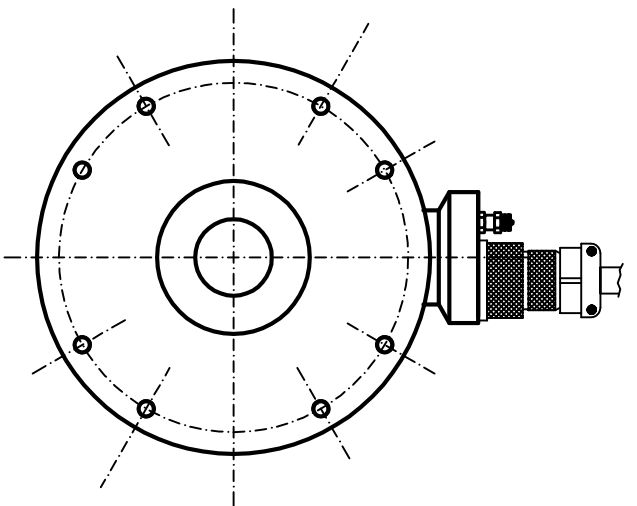
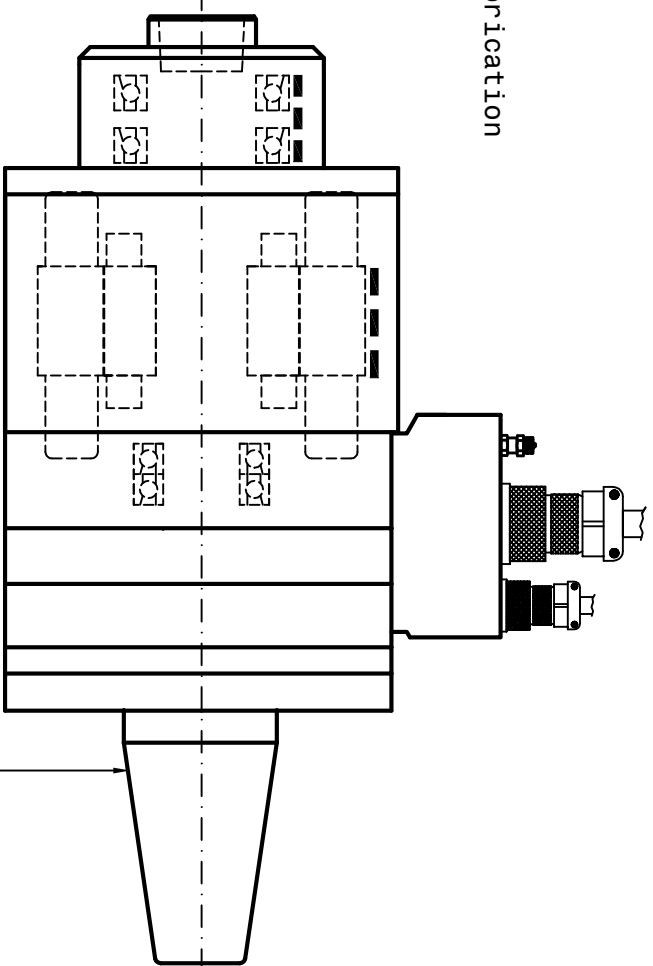

ARBOR ISO DIN 69871

SPEED	RPM	3000	6000	10000	12000	15000	24000
FREQUENCY	Hz	100	200	334	400	500	800
POWER (S1)	KW	3.5	7	12	12	12	10
TORQUE (S1)	Nm	11	11	11	9.5	7.6	4
TENSION	V	105	200	330	380	380	380
CURRENT	A	31	30	30	26	25	16

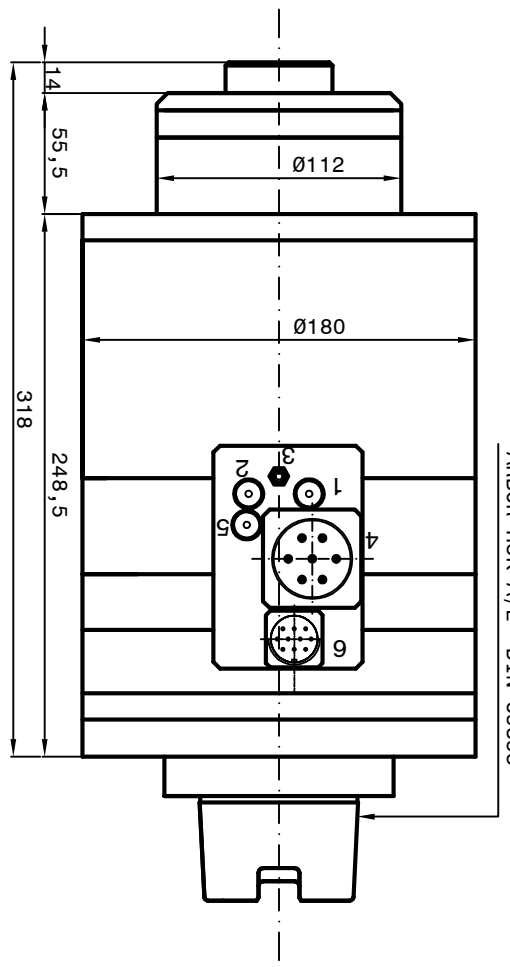
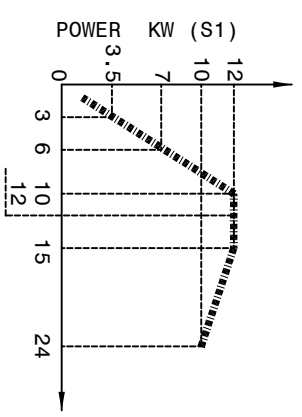
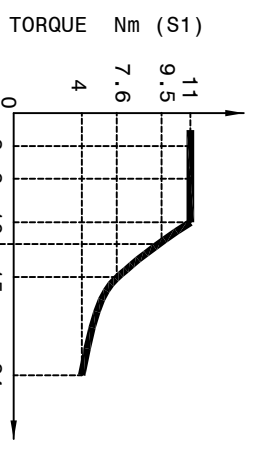

ARBOR HSK A/E DIN 69893

- Coolant inlet (G1/8") (3+4 bar) (2+3 l/min.)
  - Coolant outlet (G1/8") (5µm)
  - Front-side pressurization filtered (5µm) (1-1.5 bar) (G1/8")
  - Electric connection
  - 3-phases motor - Earth
  - Motor thermal switch (N°1 NC)
  - Inlet air tool change (G1/8) (6 bar)
  - Outlet sensor cables (S1-S2-S3)
- S1 = Toolholders clamped.  
S2 = Piston under pressure, ready to receive tools arbor.  
S3-Shaft in rotation.  
The electrospindle can not turn.

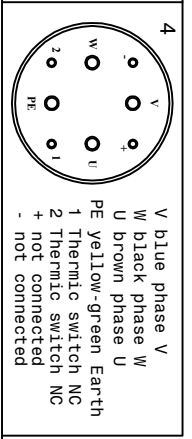
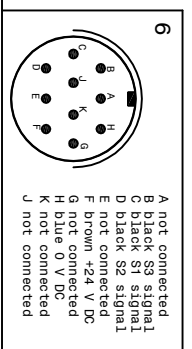

Runout arbor 0.002mm

**Peron Speed**  
INTERMOUNT

SUBJECT: PSI A-8  
CUSTOMER:

Sheet: 1/1 | Dis.n°: 186-00-03-87 | DATE: 22/08/2022