

Ceramic Hybrid Bearings 2xØ55  
 Encoder L+B GEL 2444 KN  
 1Vpp - z=128 - m=05

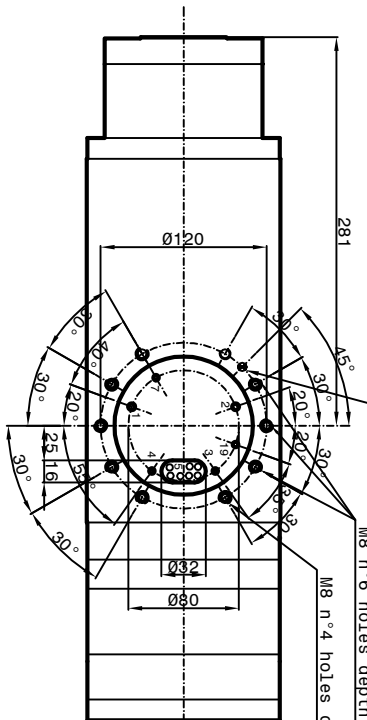

- 1-Coolant inlet (Ø5)(3+4 bar)(5+6 l/min.)
- 2-Coolant outlet (Ø5)
- 3-Hydraulic pressure unclamping tool (max 50bar - max 90bar) (Ø4)
- 4-Hydraulic pressure clamping tool (return piston) (10bar) (Ø4)
- 5-Electric connection
  - 3phases motor - Earth
  - Motor thermal switch (N°1 PTC 130)
  - Outlet sensor's cables (S1-S2-S4)
  - Outlet cables Encoder (GEL 2444 KN)
  - Motor thermal switch (N°1 PT 1000)
- S1 = Tool's arbor clamped.
- S2 = Piston under pressure ready to receive tools arbor.
- The electrospindle can not turn.
- S4 = Tool's arbor not clamped
- The electrospindle cannot turn.
- 7-Front-side pressurization filtered (5µ) (1-1.5 bar) (Ø4)
- 19-Inlet air arbor's cleaning (6 bar) (Ø4)

SPEED	RPM	2500	6000	6250	12000	20000
FREQUENCY	Hz	42.5	100	104	200	315
TORQUE (S1)	Nm	30	50	50	10	5.5
TENSION	V	112	254	264	450	420
CURRENT	A	51	61	61	31	34

Choke = 0.5 mH/phase

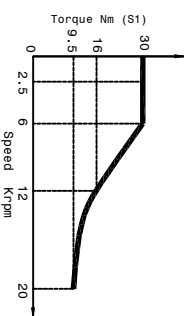
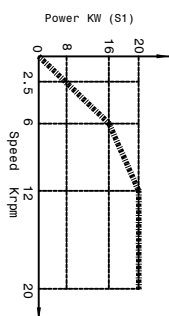

Synchronous motor: 6 poles  
Runout taper: 0.002mm

**Peron Speed** SUBJECT: PSI ES-104  
INTERMIX CUSTOMER:

Sheet: 1/1 Dis.n°3846-00-03 DATE :

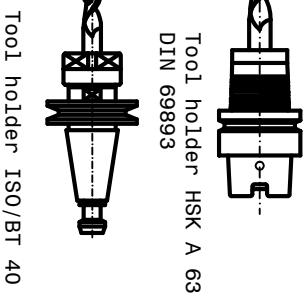
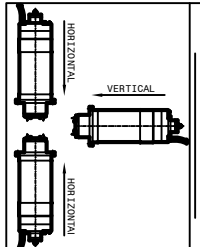

Grease Bearings Lubrication  
Cooling capacity = 3100 Watt