

Ceramic-Hybrid Bearings 2x035

355.5

Air Oil Bearings Lubrication  
 Mobil DTE Light ISO VG 32  
 Cooling capacity = 1550 Watt

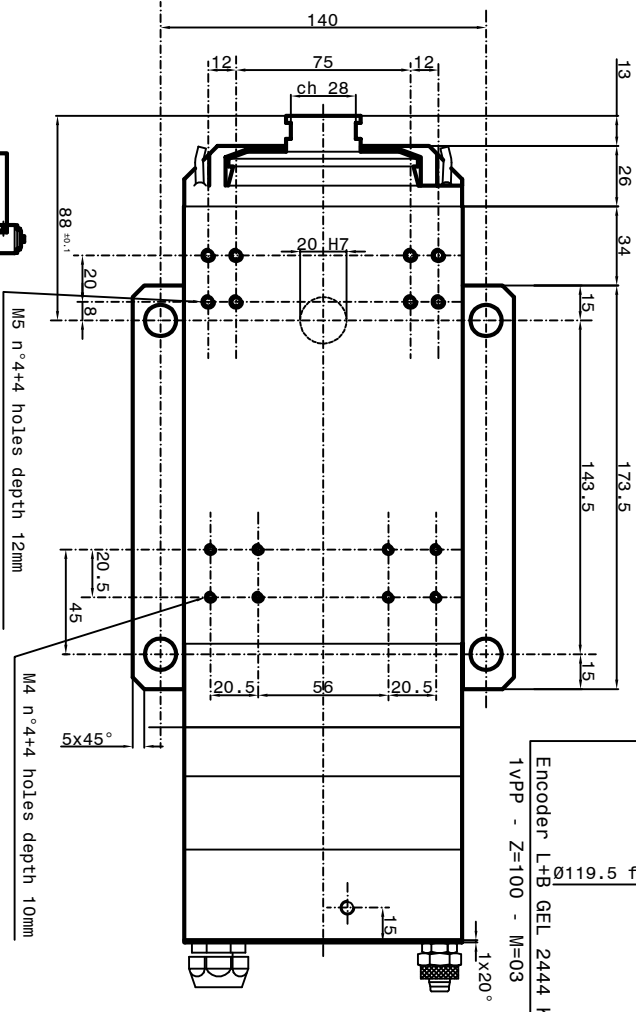
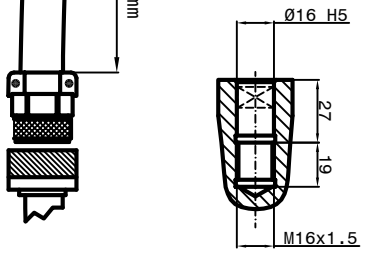
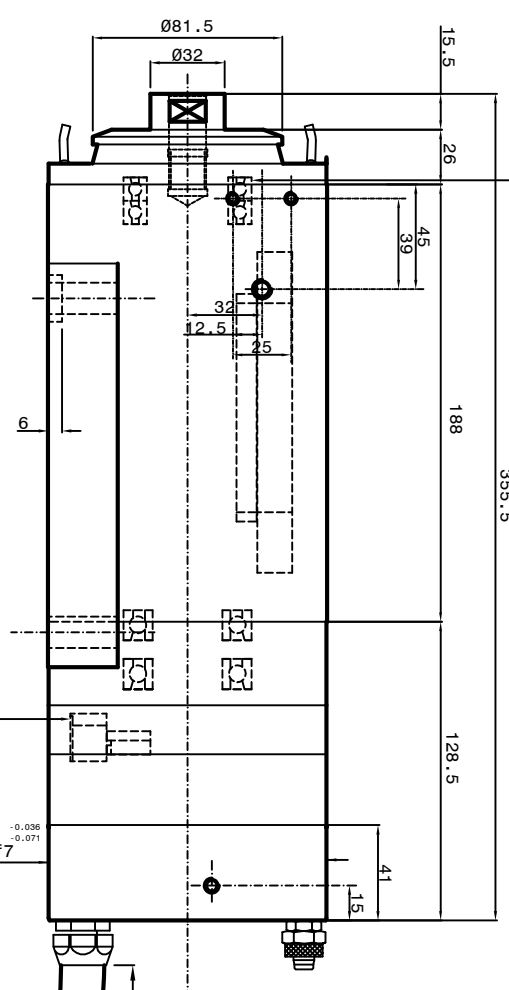
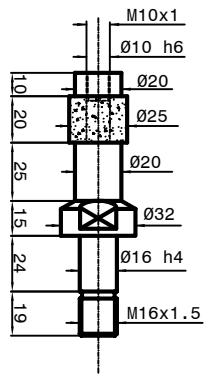
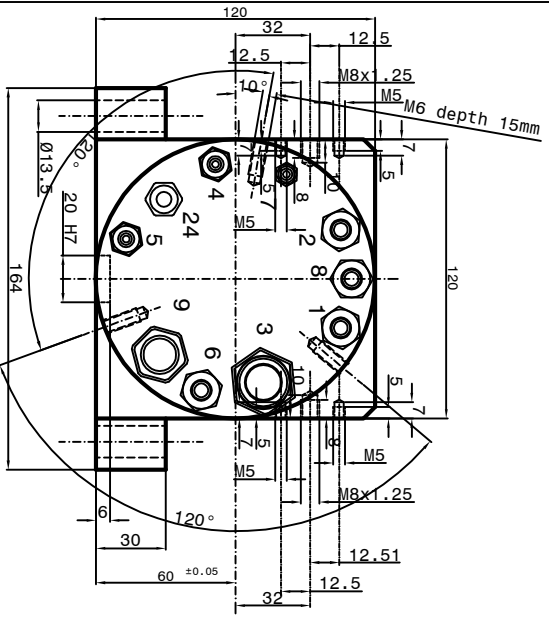

- 1-Coolant inlet (G1/4") (4 L/min.) (3-4 bar)
- 2-Coolant outlet (G1/4") (L=3000)
- 3-Electric connection (L=3000)
- 3 Phases motor - Earth
- 4-Front bearings Lubrication (G1/8")
- 5-Rear bearings Lubrication (G1/8")
- 6-Unloading Lubrication bearings (G1/8") through aspiration type Festo VAD 1/8 (6 bar)
- 7-Front-side pressurization filtered (5µm) (1-1.5 bar) (G1/8")
- 8-Tool cooling water (G1/4") (20 bar max)
- 9-Outlet encoder's cables (Gel 2444 KN) (L=3000mm)
- 24-Outlet motor thermal switch (N°1 PT 1000 + N°1 PTC 130)

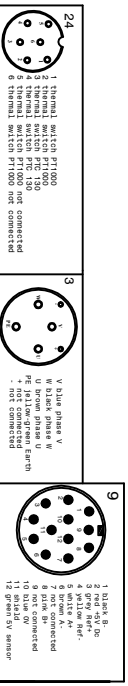

SPEED	RPM	4000	4300	5000
FREQUENCY	Hz	678	720	833
POWER (S1)	KW	9	9	9
TORQUE (S1)	Nm	2.1	2	1.7
TENSION (S1)	V	330	350	350
CURRENT (S1)	A	24	24	23
				20

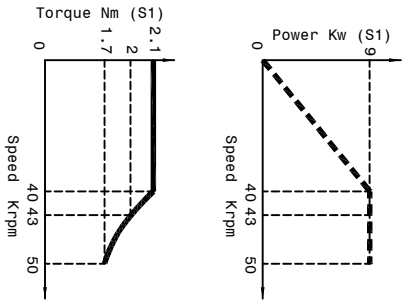

Asynchronous motor : 2 poles  
 Runout taper 0.002mm

**Paron Speed**  
 SUBJECT: PSI RGV-120  
 CUSTOMER:  
 Sheet: 1/1  
 Dls: n° 5583-00-01  
 DATE: 14/02/202