

Tool Holder HSK-A63  
DIN 69893

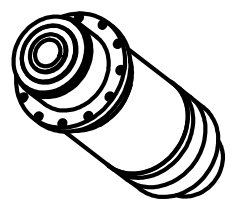
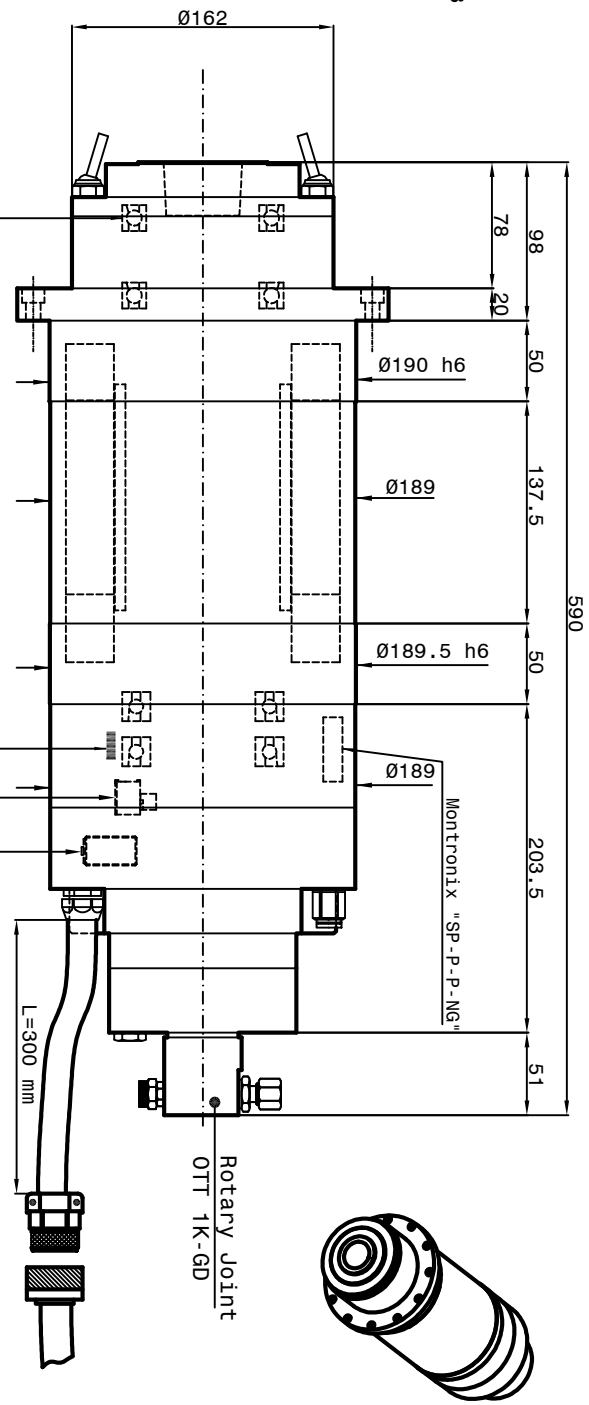
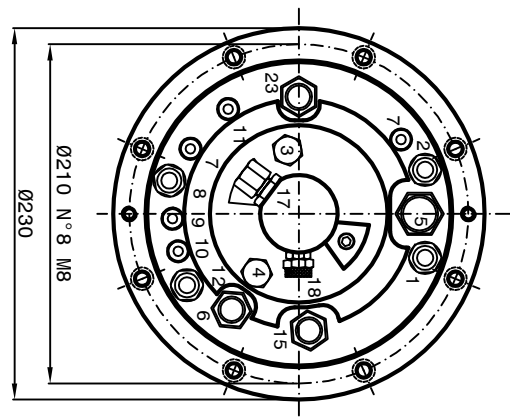

Ceramic-Hybrid Bearings 2xØ70

Rotary Joint  
OTT 1K-GD

Analogic sensor Balluff

ENCODER L+B GEL 2444 KN

1Vpp - Z=256 - m=03

PT 100 Bearings Temperature Sensor

SPEED	5000	10000	20000	30000	34000
FREQUENCY	Hz	167	333	667	1000
POWER (S1)	Kw	17	33	68	100
TORQUE (S1)	Nm	32	32	32	27
TENSION (S1)	V	101	199	396	592
CURRENT (S1)	A	105	105	105	89

Cooling capacity = 15150 Watt  
Air-Oil Bearings Lubrication  
Mobil DTE Light ISO VG 32

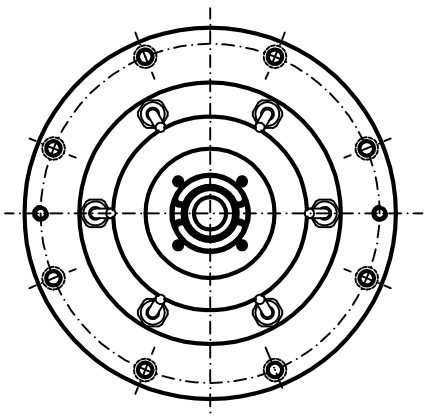

- 1-Coolant inlet (G1/2") (3+4 bar) (10+12 L/min.)
- 2-Coolant outlet (G1/2")
- 3-Hydraulic pressure unclamping tool (50barmin.-90 bar max) (G1/4")
- 4-Hydraulic pressure clamping tool (return piston) (50bar max) (G1/4")
- 5-Electric connection
- 3Phases motor - Earth
- 6-Outlet sensor's cables (S6)
- S6 = Analogic sensor Balluff
- PT 100 Bearing's temperature sensor
- 7-Front-side pressurization filtered (5µm) (1-1.5 bar) (G1/8")
- 8-Tool cooling (G3/8") (20 bar)
- 9-Front bearings Lubrication -1 (G1/8")
- 10-Front bearings Lubrication -2 (G1/8")
- 11-Rear bearings Lubrication (G1/8")
- 12-unloading Lubrication bearings (G1/4")
- 13-through aspiration type Festo VAD 1/4
- 15-outlet encoder's cables (Gel 2444 KN) Motor thermich switch (N°1 PT 1000)
- 17-Tool's Lubro refrigerant inlet by rotary (80 bar) joint (G1/4")
- Inlet air arbor's cleaning (6 bar)
- 18-Rotary joint Leakage outlet (G1/8")
- 23-outlet cables Monttronix Spectra pulse

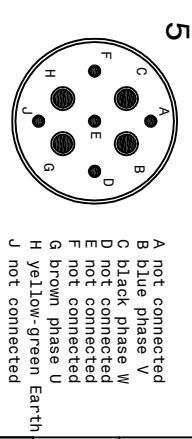

17 brown +24 V Dc  
2 blue 0 V Dc  
3 black S1 signal  
4 black S2 signal  
5 not connected  
6 black S4 signal  
7 not connected  
8 not connected  
9 PT 100  
10 PT 100  
11 shield  
12 PT 100

1 white A+  
2 brown A-  
3 grey Ref+  
4 not connected  
5 not connected  
6 not connected  
7 blue 0V  
8 white-red thermal switch PT 1000  
9 white-red thermal switch PT 1000  
10 red +5V Dc  
11 pink B+  
12 black B-  
13 yellow Ref-  
14 not connected  
15 blue 0V  
16 green 5V sensor  
17 not connected

A not connected  
B blue phase V  
C black phase W  
D not connected  
E not connected  
F not connected  
G brown phase U  
H yellow-green Earth  
J not connected

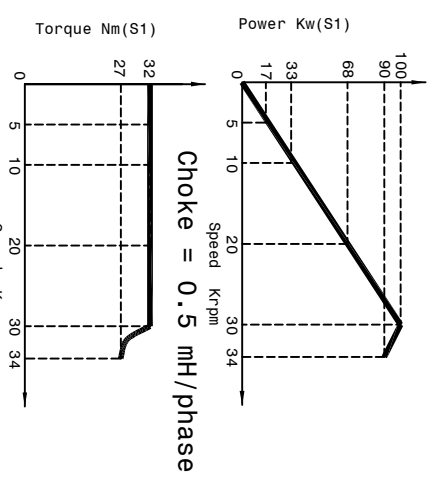

Synchronous Motor: 4 poles  
Runout taper: 0.002mm

**Peron Speed**  
SUBJECT: PSI TCV-126  
CUSTOMER: