

Tool Holder HSK-A63/100
DIN 69893

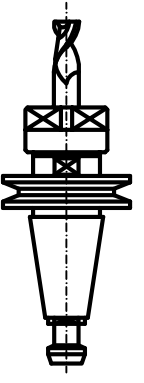
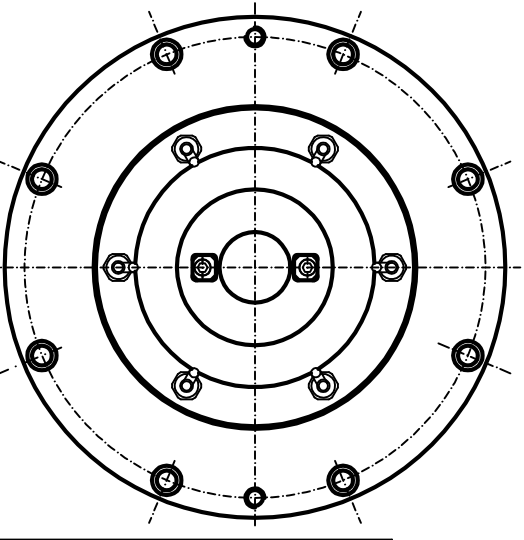
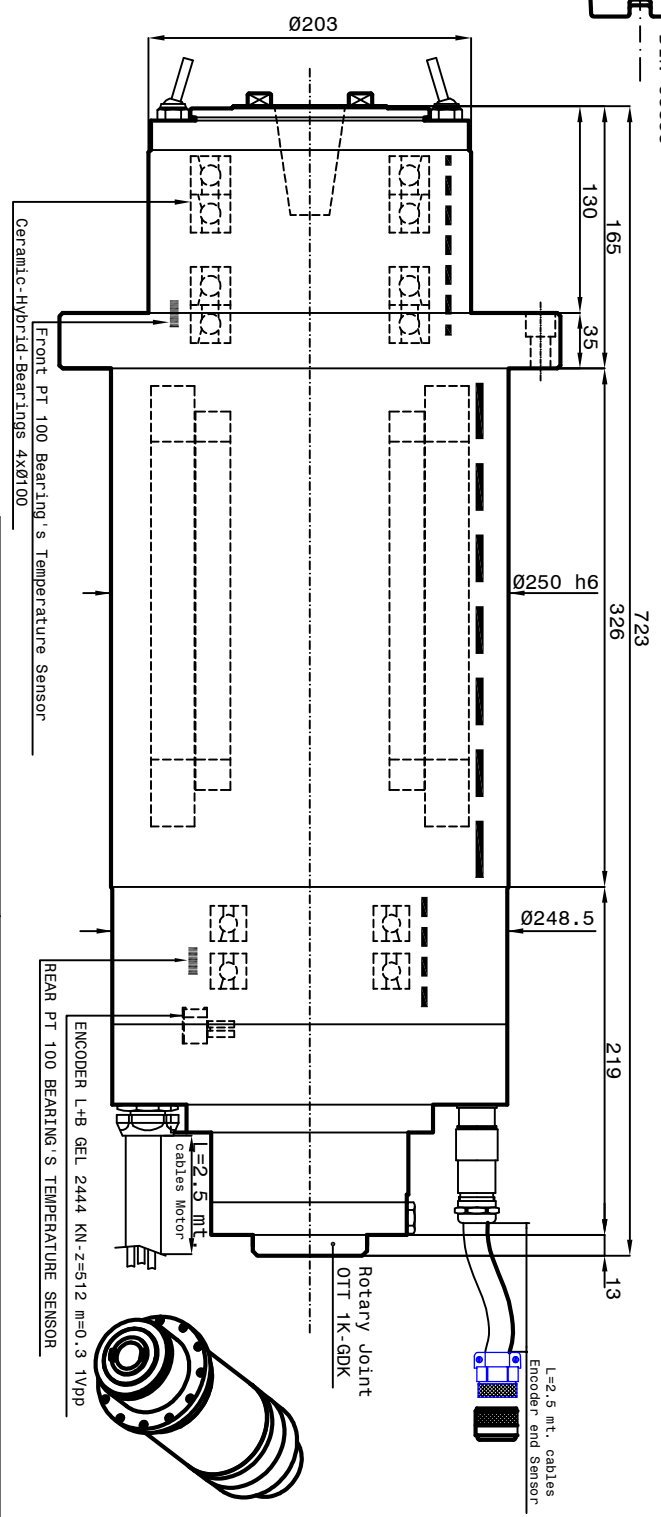
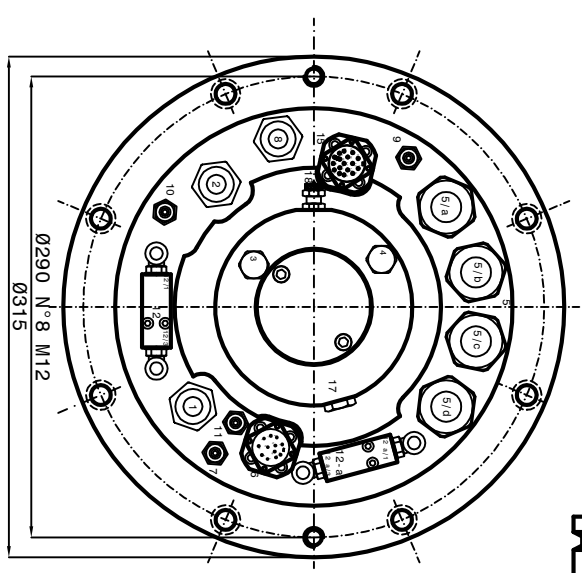

Tool holder ISO/BT 40/50

Coolant capacity = 7900 Watt Air-Oil Bearings Lubrication

- Coolant inlet (G1/2") (3-4 bar) (10 L/min.)
- Coolant outlet (G1/2")
- Hydraulic pressure unclamping tool (min 80bar - max 90bar) (G1/4")
- Air pressure clamping tool (Return piston) (6bar max) (G1/4")
- Electric connection (L=2.5 mt.)
- 3 phases motor - Earth
- 5/a Phase V n°2 cables Ø8 mm Ø10 mm
- 5/b Phase W n°2 cables Ø8 mm Ø10 mm
- 5/c Phase N°2 cables Ø8 mm Ø10 mm
- 6-Outlet sensor's cables (S1-S2-S4) (L=2.5 mt.)
- S1 PNP = Toolholders clamped.
- S2 PNP = Piston under pressure ready to receive tools arbor.
- The electrospindle can not turn.
- S4 PNP = Toolholders not clamped. The electrospindle cannot turn.
- PT 100 bearing's temperature sensor (L=1.5 bar) (G1/8")
- 7-Front bearing's temperature sensor (L=1.5 bar) (G1/8")
- 8-Front cooling water (G1/2") (20 bar)
- 9-Front bearings lubrication -1 (G1/8")
- 10-Front bearings lubrication -2 (G1/8")
- 11-Rear bearings lubrication (G1/8")
- 12-unloading lubrication rear bearings (G1/8") (FESTO VAD 1/4")
- 12/3-unloading air inlet for aspiration oil (M5) (6 bar)
- 12/a-unloading air-oil bearings (G1/4") (6 bar)
- 12/b-unloading air-oil bearings (Ø6) (FESTO VAD 1/4")
- 12-c/1-unloading air inlet for aspiration oil (G1/4") (6 bar)
- 12-d/3-outlet air-oil bearings (G1/4")
- 15-outlet encoder's cables (Gel 2444 KN) (L=2.5 mt.)
- Motor thermal switch (N°1 PT 1000)
- 17-Tool's Lubro refrigerant inlet by rotary joint (80 bar) (G1/4")
- Inlet air arbor's cleaning (6 bar)
- The electrospindle cannot turn.
- Inlet air 5 bar 10000 RPM
- 18-Rotary joint leakage outlet (G1/8")

15 Connector Hummel M23 17 pin Z.001.917.103+7.001.917.104

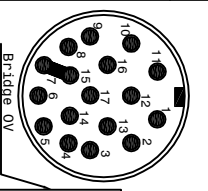

- White A+
 - brown A-
 - grey Ref+
 - not connected
 - not connected
 - not connected
 - white OV
 - white OV
 - thermal switch PT 1000
 - white-red thermal switch PT 1000
 - red +5V Dc
 - pink B-
 - black B-
 - yellow Ref-
 - not connected
 - blue OV
 - green 5V sensor
 - not connected
 - not connected
- screen on carcass

6 Connector Hummel M23 17 pin Z.001.912.103+7.001.912.104

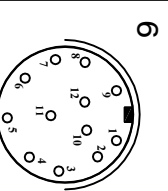

- Brown +24 V Dc
- blue 0 V Dc
- black S1 signal
- black S2 signal
- black S3 signal
- black S4 signal
- rear connected
- rear PT 100
- front PT 100
- shield
- front PT 100

SPEED	RPM	1200	2880	3200	6200	10000
FREQUENCY	Hz	39	194	217	415	1200
POWER (S1)	Nm	32	52	52	82	12
TORQUE (S1)	Nm	172	172	154	31	13.3
CURRENT (S1)	A	126	126	117	104	38
POWER (S6-40% 2 mt.)	Nm	28.6	66	66	99	13
TORQUE (S6-40% 2 mt.)	Nm	238	238	202	99	10.3
EMSION (S6-40% 2 mt.)	V	150	346	380	380	380
CURRENT (S6-40% 2 mt.)	A	138	155	140	137	42

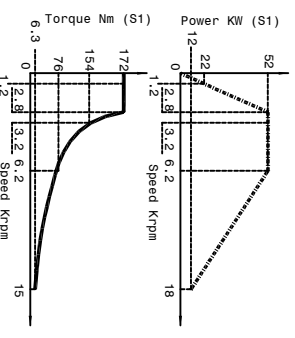

Asynchronous motor: 8 poles Runout taper 0.002mm

Peron Speed CUSTOMER: SUBJEC: PS TCY-212