

- 1-Coolant inlet (G1/8") (3-4 bar)
- 2-Coolant outlet (G1/8")
- 3-Front-side pressurization filtered (5µm) (1-1.5 bar) (M6)
- 4-Electric connection (L=300)
- 3 Phases motor - Earth
- Motor thermal switch (N°1 NC)

SPEED	RPM	20000	40000
FREQUENCY	HZ	334	667
POWER (S1)	KW	2.5	4
TORQUE	Nm	1.2	1
TENSION	V	190	380
CURRENT	A	7	7

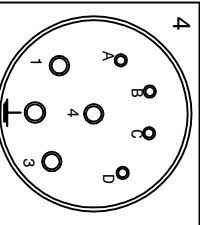
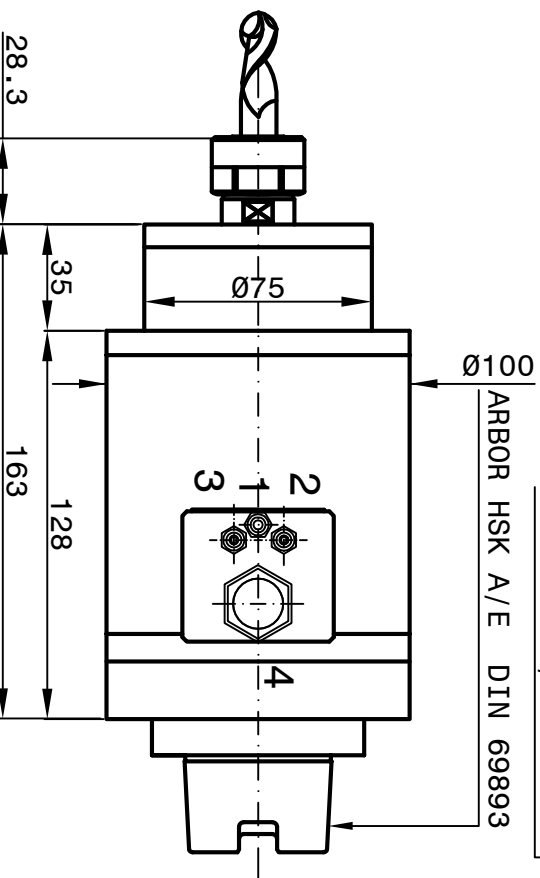
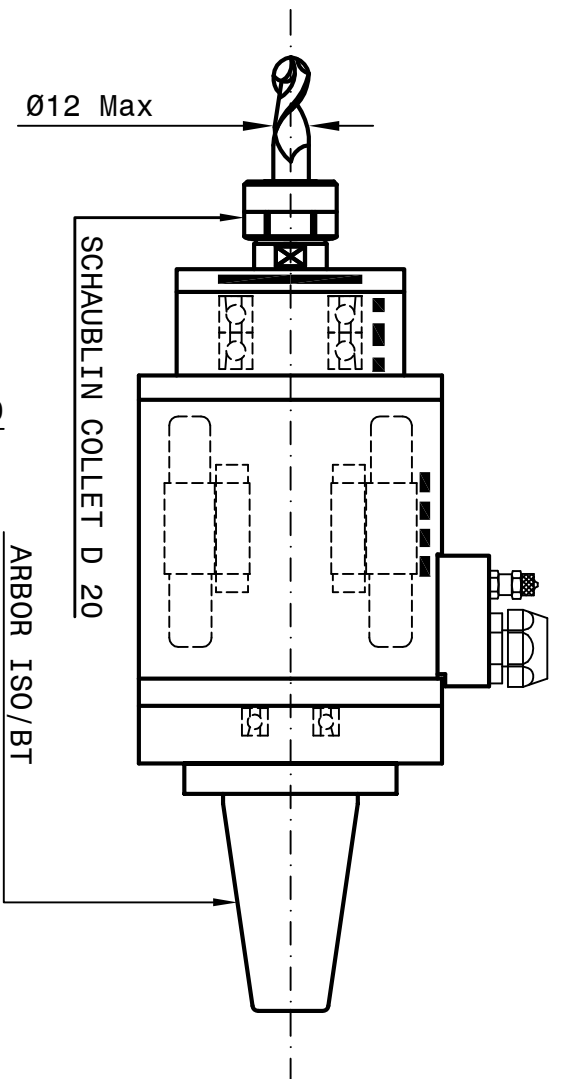

- 1 brown phase U
- 2 yellow-green Earth
- 3 blue phase V
- 4 black phase W
- A thermic switch NC
- B thermic switch NC
- C not connected
- D not connected

Peron Speed
INTERNATIONAL

Sheet: 1 / 1 Dwg. N° 230 - 00 DATE : 22 / 08 / 2022

SUBJECT : PSI A-9

CUSTOMER :

Runout arbor 0.002mm