

- 1 Brown +24 V DC
- 2 Blue -12 V DC
- 3 Black S1 signal
- 4 Black S2 signal
- 5 Black S3 signal
- 6 Black S4 signal
- 7 not connected
- 8 not connected
- 9 not connected
- 10 not connected
- 11 not connected
- 12 not connected

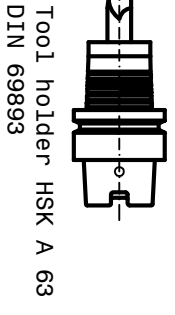

Tool holder HSK A 63  
DIN 69893

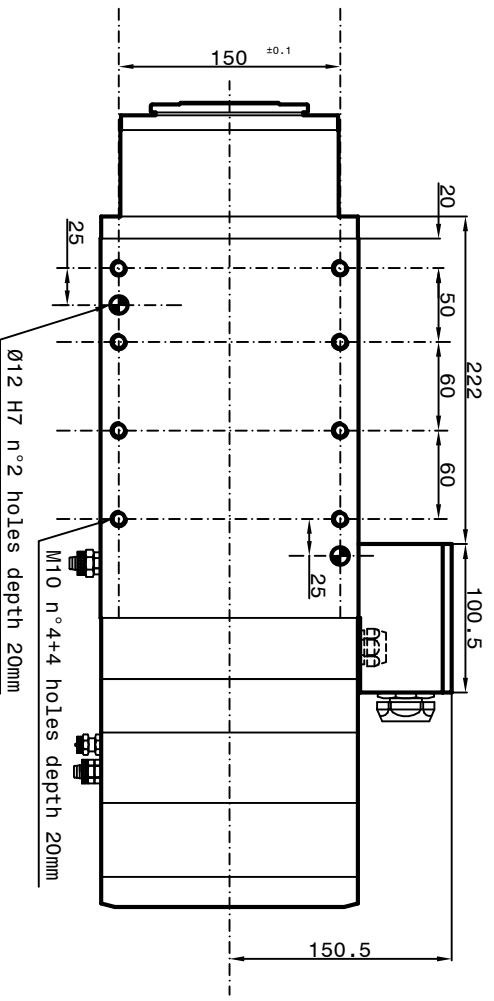
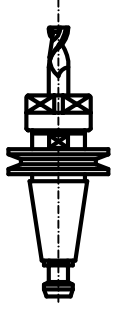

Tool holder ISO/BT 40

Grease Bearings Lubrication  
Cooling capacity = 3150 Watt

- 1 - Coolant inlet (G1/8") (3+4 bar) (5+6 l/min.)
- 2 - Coolant outlet (G1/8")
- 3 - Inlet air tool change (6 bar) (G1/8")  
(to be used only with arrested electrospindle)
- 4 - Inlet air return piston (6 bar) (G1/8")
- 5 - Electric connection  
applies motor-earth  
Motor thermisch switch (N°1 PTC 130)  
outlet sensor's cables (S1-S2-S3-S4)
- 6 - outlet sensor's cables (S1-S2-S3-S4)  
The electrospindle can not turn.  
S1 = Tool's arbor clamped.  
S2 = Piston under pressure ready to receive tools arbor
- 7 - Front-side pressurization filtered (5p)  
(1-1.5 bar) (G1/8")
- 19 - Inlet air arbor's cleaning (6bar max) (G1/8")

SPEED	RPM	1600	12000
FREQUENCY	Hz	204	400
POWER (S1)	KW	20	20
TORQUE (S1)	Nm	32	16
TENSION	V	380	380
CURRENT	A	42	40

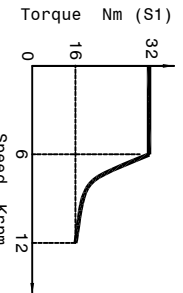
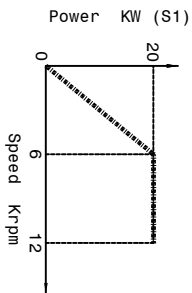

Asynchronous motor: 4 poles  
Runout taper 0.002mm

**Peron Speed**  
SUBJECT: PSI ES-108  
CUSTOMER:

Sheet: 1/1  
Dis. n° 4967-00-03  
DATE :