

Tool holder HSK A 100  
DIN 69893

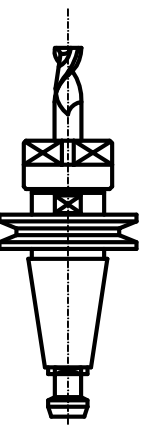

Tool holder ISO/MT 50

Grease Bearings Lubrication  
Cooling capacity=8200 Watt

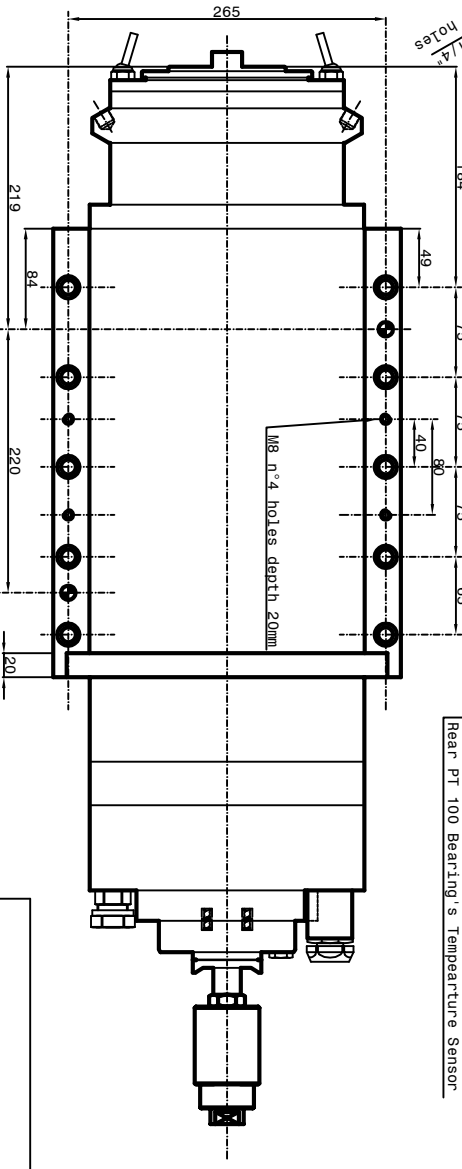
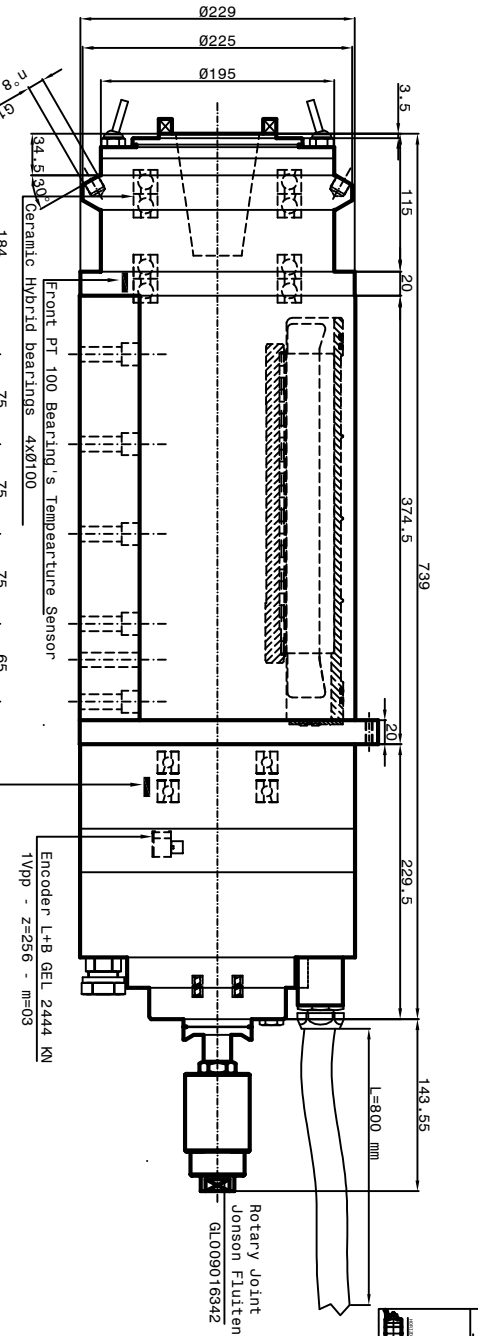

- 1-Coolant inlet (G1/2") (3-4 bar) (10 L/min.)
- 2-Coolant outlet (G1/2")
- 3-Hydraulic pressure unclamping tool (min 80bar - max 90bar) (G1/4")
- 4-Hydraulic pressure clamping tool (Return piston) (10bar max) (G1/4")
- 5-Electric connection (L=800)
- 3 Phases motor - Earth
- Phases motor U n°1 cable 35mm<sup>2</sup> + Earth Ø10
- Phases motor V n°1 cable 35mm<sup>2</sup> + Earth Ø10
- Phases motor W n°1 cable 35mm<sup>2</sup> + Earth Ø10
- 6-Outlet sensor's cables (S1-S2-S4) (L=800mm)
- S1 PNP = Toolholders clamped Ø4
- S2 PNP = piston under pressure ready to receive tools arbor Ø4
- The electrospindle can not turn.
- S4 PNP = Toolholders not clamped Ø4
- The electrospindle cannot turn.
- PT 100 Bearing's temperature sensor (1-1.5 bar) (Ø4)
- 7-Front-side pressurization filter (5µm)
- 8-Tool cooling water (Ø3/8") (20 bar)
- 15-Outlet encoder's cables (Gel 2444 KN) (L=800mm)
- Motor thermal switch (N°1 PT 1000)
- 17-Tool's Lubro refrigerant inlet by rotary (80 bar) joint (G1/4")
- Inlet air arbor's cleaning (6 bar)

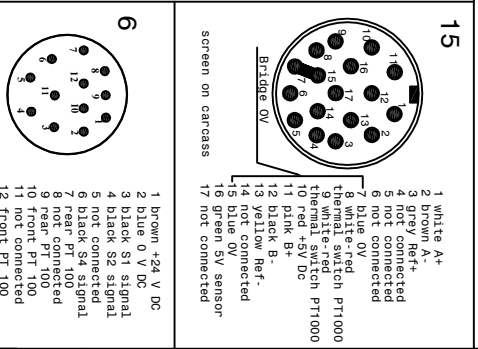

1 white A+	2 brown A+	3 grey Ref+	4 not connected	5 not connected	6 not connected	7 blue 0V	8 white-red thermal switch PT1000	9 red +5V DC	10 red +5V DC	11 pink B+	12 black B-	13 yellow Ref-	14 not connected	15 green 5V sensor	16 green 5V sensor	17 not connected
------------	------------	-------------	-----------------	-----------------	-----------------	-----------	-----------------------------------	--------------	---------------	------------	-------------	----------------	------------------	--------------------	--------------------	------------------

1 brown +24 V DC	2 blue 0 V DC	3 black S1 signal	4 black S2 signal	5 not connected	6 black S4 signal	7 rear PT 100	8 rear PT 100	9 rear PT 100	10 front PT 100	11 not connected	12 front PT 100
------------------	---------------	-------------------	-------------------	-----------------	-------------------	---------------	---------------	---------------	-----------------	------------------	-----------------

SPEED	RPM	1700	10000
POWER (S1)	KW	53	53
TORQUE (S1)	Nm	307	50
TENSION (S1)	V	424	MAX
CURRENT (S1)	A	215	MAX

Power KW (S1)	53
Torque Nm (S1)	307
Speed Krpm	10

SUBJECT: PS ES-206  
CUSTOMER:

