

Tool holder HSK A 63
DIN 69893

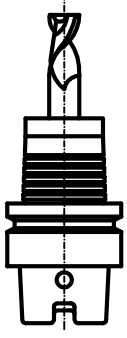

Tool holder ISO/BI 40

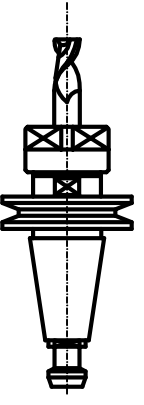

- 1-Coolant inlet (06)(3-4 bar)-(6-7 l/min.)
- 2-Coolant outlet (06)
- 3-Hydraulic pressure unclamping tool (min 80bar - max 90bar) (06)
- 4-Hydraulic pressure clamping tool (Return piston)(100bar max) (06)
- 5-Electrical connection (L=2500)
- 6-Phases motor U n.2 cables 06
- 7-Phases motor V n.2 cables 06
- 8-Earth n.2 cables 06
- 9-Outlet sensor's cables (S1-S2-S4)(L=2000mm)
- S1 PMP = Piston under pressure ready
- S2 PMP = Toolholders clamped 04
- S4 PMP = Toolholders not clamped 04
- The electroswitch can not turn.
- 10-Rear bearings Lubrication -1 (04)
- 11-Unloadng Lubrication bearings (06)
- 12-Rear bearings Lubrication -1 (04)
- 13-Rear bearings Lubrication -1 (04)
- 14-Tool's Lubro refrigerant inlet by rotary joint(06)
- 15-Inlet air arbor's cleaning (6 bar)

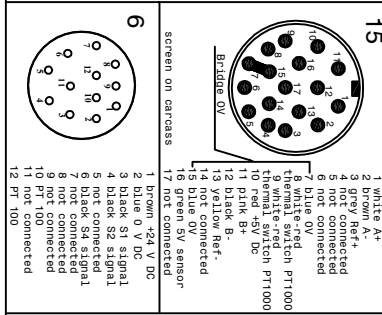

REVIZIONE	DATA	DESCRIZIONE
01	10/04/2010	PROTOTIPO
02	10/04/2010	PROTOTIPO
03	10/04/2010	PROTOTIPO
04	10/04/2010	PROTOTIPO
05	10/04/2010	PROTOTIPO
06	10/04/2010	PROTOTIPO
07	10/04/2010	PROTOTIPO
08	10/04/2010	PROTOTIPO
09	10/04/2010	PROTOTIPO
10	10/04/2010	PROTOTIPO
11	10/04/2010	PROTOTIPO
12	10/04/2010	PROTOTIPO
13	10/04/2010	PROTOTIPO
14	10/04/2010	PROTOTIPO
15	10/04/2010	PROTOTIPO
16	10/04/2010	PROTOTIPO
17	10/04/2010	PROTOTIPO
18	10/04/2010	PROTOTIPO
19	10/04/2010	PROTOTIPO
20	10/04/2010	PROTOTIPO
21	10/04/2010	PROTOTIPO
22	10/04/2010	PROTOTIPO
23	10/04/2010	PROTOTIPO
24	10/04/2010	PROTOTIPO
25	10/04/2010	PROTOTIPO
26	10/04/2010	PROTOTIPO
27	10/04/2010	PROTOTIPO
28	10/04/2010	PROTOTIPO
29	10/04/2010	PROTOTIPO
30	10/04/2010	PROTOTIPO
31	10/04/2010	PROTOTIPO
32	10/04/2010	PROTOTIPO
33	10/04/2010	PROTOTIPO
34	10/04/2010	PROTOTIPO

Torque Nm (S1)

Power Kw (S1)

Asynchronous motor: 4 poles
Runout taper: 0.002mm

Paron Speed OGGETTO: PSI ES-213
CUSTOMER:

Sheet: 1/1 Dfs.n°119-00 DATE :

Air-Oil Bearings Lubrication
MOBIL DTE Light ISO VG 32
COOLING capacity=6450 Watt