

Cooling capacity=7750 Watt
 Air-Oil Bearings Lubrication
 Mobil DTE Light ISO VG 32

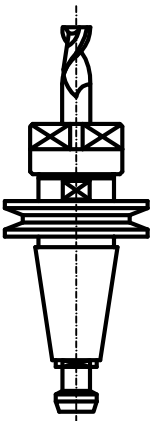

Tool holder ISO/BT 50

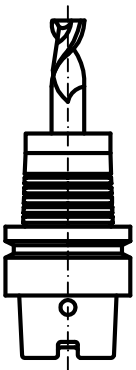
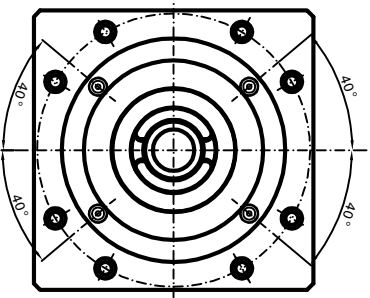

Tool Holder HSK-A100
 DIN 69893

- 1-Coolant inlet (3+4 bar) (8÷10 L/min.)
- 2-Coolant outlet (Ø8)
- 3-Hydraulic pressure unclamping tool (min 80bar - max 90bar) (G1/4")
- 4-Hydraulic pressure clamping tool (Return piston) (10bar max) (G1/4")
- 5-Electric connection (L=600mm)
 - 3 Phases motor - Earth
 - 5/a Phases U-V-n°2 cables Ø7mm
 - 5/b Phases W-n°1 cable Ø7mm
- 6-Outlet sensor's cables (S6) (L=600mm)
 - S6 = Analogic sensor Balluff
 - PT 100 Bearing's temperature sensor
- 7-Front-side pressurization filtered (5µm) (1-1.5 bar) (Ø4)
- 8-Tool cooling water (Ø8) (20 bar)
- 9-Front bearings Lubrication (Ø4)
- 11-Rear bearings Lubrication (G1/8)
- 12-Unloading Lubrication front bearings (Ø6) through aspiration type Festo VAD 1/4
- 12/a-Unloading Lubrication rear bearings (G1/4") through aspiration type Festo VAD 1/4
- 15-Outlet encoder's cables (Gel 2444 KN) (L=600mm)
 - Motor thermal switch (N°1 PT 1000)
- 17-Tool's Lubro refrigerant inlet by rotary(80 bar) joint(G1/4")
 - Inlet air arbor's cleaning (6 bar)
- 18-Rotary joint leakage outlet (G1/8")

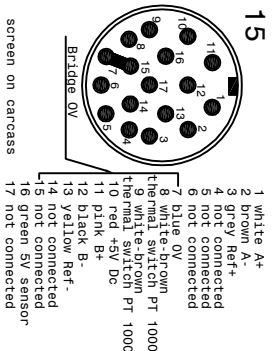

screen on carcass

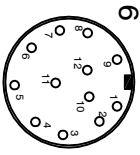

- 1 brown +24 V DC
- 2 blue 0 V DC
- 3 not connected
- 4 not connected
- 5 not connected
- 6 not connected
- 7 rear PT 100
- 8 black S6 signal
- 9 rear PT 100
- 10 not connected
- 11 not connected
- 12 not connected

Choke = 0.5 mH/phase

SPEED	3000	6000	14000	15000
FREQUENCY	Hz 150	309	700	750
POWER (S1)	KW 50	50	50	50
TORQUE (S1)	Nm 160	79	34	30
TENSION (S1)	V 249	380	380	380
CURRENT (S1)	A 166	82	89	91
POWER (S6/40%-2 min.)	KW 61	61	61	61
TORQUE (S6/40%-2 min.)	Nm 193	97	42	36
TENSION (S6/40%-2 min.)	V 284	380	380	380
CURRENT (S6/40%-2 min.)	A 206	111	99	103

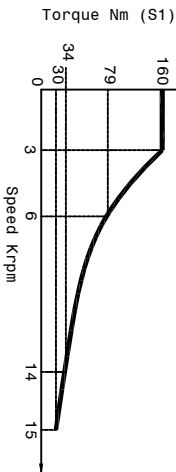
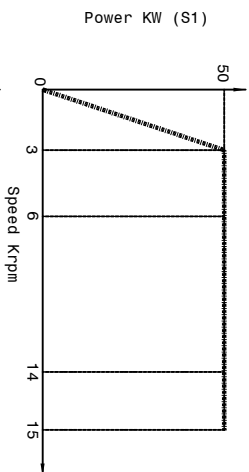

Synchronous Motor: 6 poles

Runout taper 0.002mm

Peron Speed
 INVENTORIAL CUSTOMER:
 SUBJECT: PSI TCV-S-201

Sheet: 1/1

DIS. N° 5610-00

DATE : 12/08/2022

