

TOOL HOLDER HSK-A100 DIN 69893

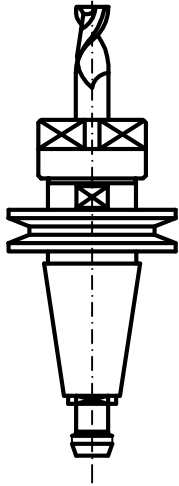
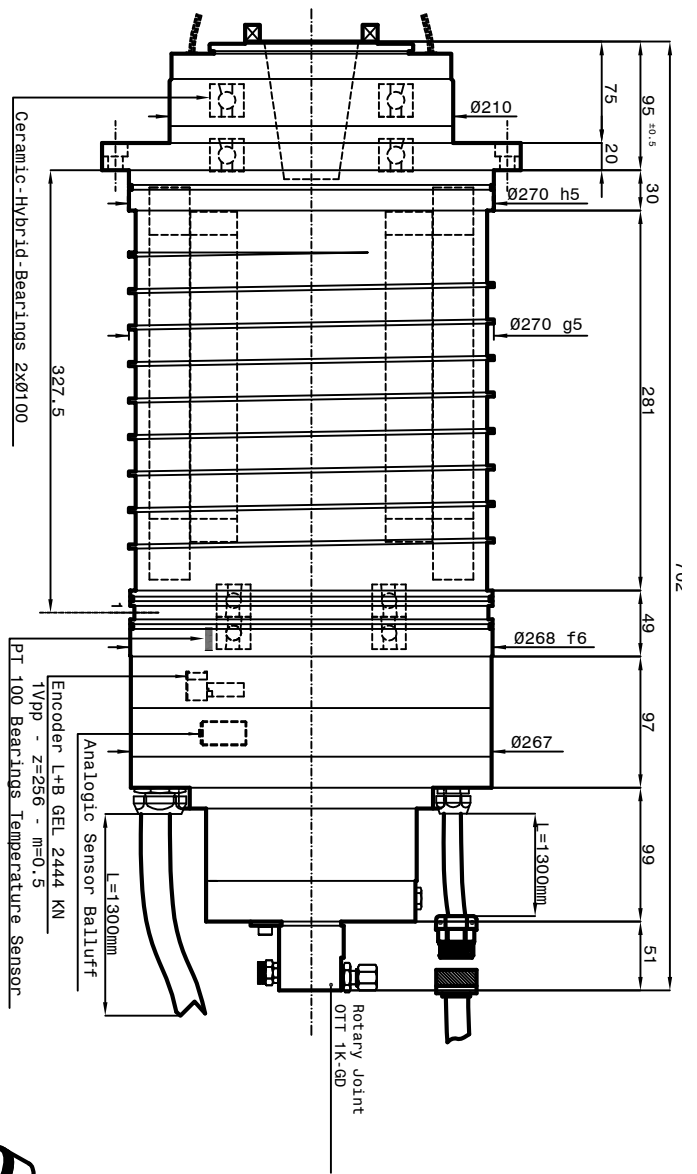

Tool holder ISO/BT 50  
DIN 69871

- 1-Coolant inlet (7-8 bar max)(14+18 l/min.)
- 2-Coolant outlet (Ø9)
- 3-Hydraulic pressure unclamping (Ø1/4")
- 4-Hydraulic pressure clamping tool (Return piston)(10bar max) (Ø1/4")
- 5-Electric connection 3 phases motor (L=1300 mm) 5/1a Phases U1-U3 V1-V3 n.3 cables 10 mm² Ø8 PE n.1 cable Ø10 (M8)(L=1300 mm)
- S1 Analogic sensor Balluff (L=1300 mm)
- S4 MP = Piston position L=1300 mm)
- S10 = PT 100 Bearing's temperature sensor (L=1300 mm)
- 7-Front-side pressurization filtered (Ø4mm) (11.5 bar) (Ø5)
- 8-100l cooling water (Ø8)(20 bar)
- 15-Outlet encoder's cables (Ø1 2444 KN)(L=1000 mm)
- 17- Motor thermal switch (N.1 PT 1000)
- 17- Tooling (Ø1/4")
- 17- Inlet air arbor's cleaning inlet by rotary(50 bar max)
- 18-Rotary joint leakage outlet (Ø1/8")

Cooling capacity = 4150 Watt  
Grease Bearings Lubrication

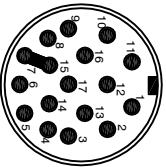

15

- screen on carcass
- 1 white A+
  - 2 brown A-
  - 3 grey Ref+
  - 4 not connected
  - 5 not connected
  - 6 blue OV
  - 7 white- red thermal switch PT1000
  - 8 red +5V Dc
  - 9 yellow Ref-
  - 10 pink B+
  - 11 black B-
  - 12 not connected
  - 13 blue OV
  - 14 not connected
  - 15 green 5V sensor
  - 16 green OV
  - 17 not connected

PERIOD	1025	1250	1500
FREQUENCY	102	150	1500
POWER (S1)	26	26	26
TORQUE (S1)	Nm 261	107	31.3
TENSION (S1)	V 170	400	400
CURRENT (S1)	A 1.25	4.7	4.7
POWER (S8 60% 2 min.)	KN 30	30	30
TENSION (S8 60% 2 min.)	V 170	400	400
CURRENT (S8 60% 2 min.)	A 1.44	4.6	5.4

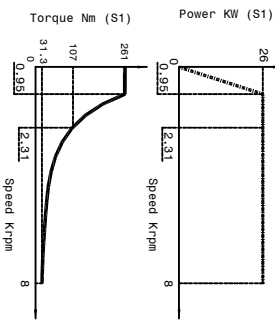

Asynchronous motor: 8 poles

Runout taper: 0.002mm

**Paron Speed** SUBECT: PSI TCV-S-210

Sheet: 1/1 DIS. N° 5865-00 DATE: 17/08/2022

