

Tool Holder HSK-A63  
DIN 69893

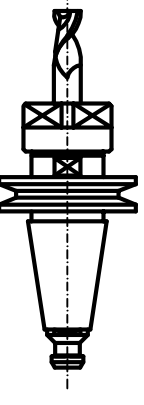

Tool holder ISO/BT 40

**Cooling capacity = 5750 Watt**  
**Air-Oil Bearings Lubrication**  
**Mobil DTE Light ISO VG 32**

- 1-Coolant inlet (G1/4") (3+4 bar) (5+6 L/min.)
- 2-Coolant outlet (G1/4")
- 3-Hydraulic pressure unclamping tool (min 50bar - max 90bar) (G1/4")
- 4-Hydraulic pressure clamping tool (Return piston) (10bar max) (G1/4")
- 5-Electric connection
- 6-Phases motor - Earth L= 1000 mm
- 6-Outlet sensor's cables (S1-S2-S4-S7-S8) L= 1000 mm
- S1 = Tool's arbor clamped.
- S2 = Piston under pressure ready to receive tool's arbor.
- S4 = Tool's arbor not clamped.
- S7 = The electrospindle cannot turn.
- S8 = Sensor taper unlock.
- S9 = Sensor taper lock.
- 7-Front-side pressurization filtered (5µm) (1-1,5 bar) (G1/8")
- 8-Tool cooling water (G1/8") (20 bar)
- 9-Front bearings Lubrication 1 (G1/8")
- 10-Front bearings Lubrication 2 (G1/8")
- 11-Rear bearings Lubrication (G1/8")
- 12-Uploading Lubrication bearings (G1/8") through aspiration type Festo VAD 1/8 (6 bar)
- 15-Output encoder's cables (Gel 2444 KN) L= 1000 mm
- 17-Tool's turbo refrigerant inlet by rotary (80 bar) joint (G1/4")
- 18-Inlet air arbor's cleaning (6 bar)
- 21-Rotary joint leakage outlet (G1/8")
- 22-Oil inlet to unlock the shaft (60bar) (G1/4")

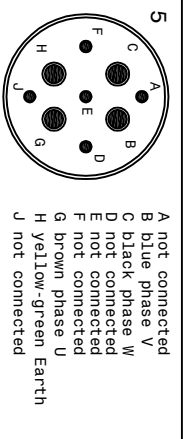
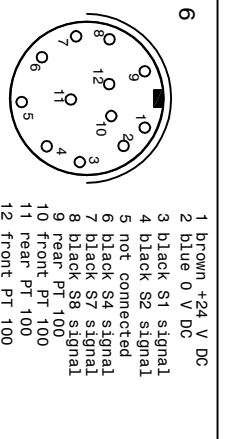
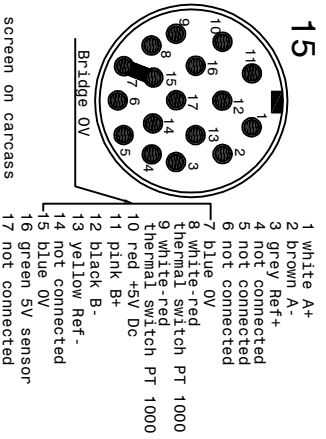

SPEED	RPM	2000	8000	10000	18000	24000	30000
FREQUENCY	Hz	108	420	532	900	1200	1500
POWER (S1)	KW	9	37	37	37	32	27
TORQUE (S1)	Nm	43	43	36	20	13	8.5
TENSION	V	78	300	380	380	380	380
CURRENT	A	98	96	80	73	67	59

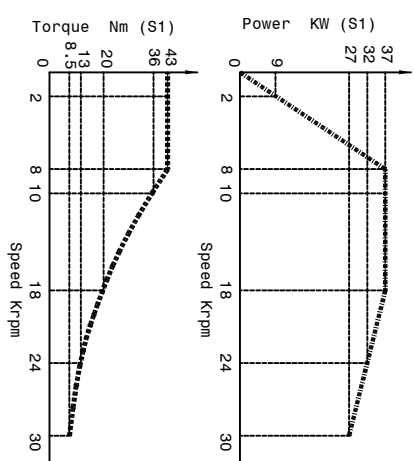

Asynchronous motor: 6 poles Runout taper 0.002mm



SUBJET: PSI TCV-T-106  
CUSTOMER: